

PRODUCT SPECIFICATIONS

Elkay Multi-Station Fountain, Non-Filtered Non-Refrigerated Stainless. Furnished with Flexi-Guard® Safety Bubbler. Mechanical Top Bubbler Button activation. Product shall be Wall Mount (On Wall), for Indoor + Outdoor applications, serving 3 station(s). Unit shall be lead-free design which is certified to NSF/ANSI 61 & 372 (lead free) and meets Federal and State low-lead requirements.

Finish:	Stainless Steel
Power:	No Electrical Required
Bubbler Style:	Flexi-Guard® Safety Bubbler
Activation by:	Mechanical Top Bubbler Button
Mounting Type:	Wall Mount (On Wall)
Chilling Capacity:	Non-refrigerated
Dimensions (L x W x H):	52" x 14" x 15"
Approx. Shipping Weight:	51 lbs.
Installation Location:	Indoor + Outdoor
No. of Stations Served:	3

**When used in non-temperature controlled environments, unit(s) must be adequately winterized and/or protected from extreme heat to prevent damage where climates dictate.

- Mechanically-Activated bubbler continues to supply water in event of service disruptions.



Included with Product: Fountain
Ships in one box.

AMERICAN PRIDE. A LIFETIME TRADITION. Like your family, the Elkay family has values and traditions that endure. For almost a century, Elkay has been a family-owned and operated company, providing thousands of jobs that support our families and communities.



PRODUCT COMPLIANCE

ASME A112.19.3/CSA B45.4

Buy American Act

NSF/ANSI 61 & 372 (lead free)



[Installation Instructions \(PDF\)](#)

Water Systems are warranted for 12 months from date of installation.

Warranty pertains to drinking water applications only. Non-drinking water applications are not covered under warranty.

[Warranty \(PDF\)](#)

PART: _____ QTY: _____

PROJECT: _____

CONTACT: _____





DATE: _____

NOTES: _____

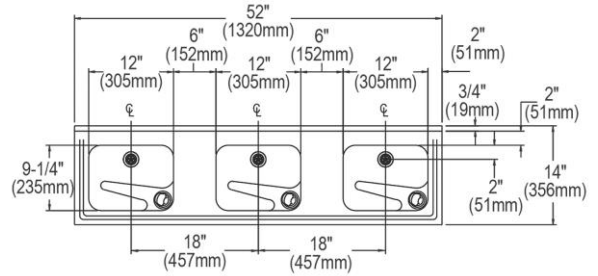
APPROVAL: _____

In keeping with our policy of continuing product improvement, Elkay reserves the right to change product specifications without notice. Please visit elkay.com for the most current version of Elkay product specification sheets. This specification describes an Elkay product with design, quality, and functional benefits to the user. When making a comparison of other producers' offerings, be certain these features are not overlooked.



Optional Accessories		
EWF172	Elkay WaterSentry VII Filter Kit (Coolers + Fountains) Spec Sheet (PDF)	
97446C	Accessory - Bubbler Kit Vandal-Resistant Spec Sheet (PDF)	
LK1110	Elkay Glass Filler Spec Sheet (PDF)	
LK1114	Elkay Glass Filler Chrome 2-1/2" x 10" Spec Sheet (PDF)	

In keeping with our policy of continuing product improvement, Elkay reserves the right to change product specifications without notice. Please visit elkay.com for the most current version of Elkay product specification sheets. This specification describes an Elkay product with design, quality, and functional benefits to the user. When making a comparison of other producers' offerings, be certain these features are not overlooked.

INSTALLATION INSTRUCTIONS

1. Remove lower panel from drinking fountain by removing the two screws at the lower corners. Rotate the bottom of the panel out and pull gently downward to remove.
2. Water inlet tube to be 3/8" O.D. Waste tailpiece for slip trap is 1-1/4" O.D. Contractor to supply waste trap in accordance with local codes.
3. Connecting lines to be copper and thoroughly flushed to remove all foreign matter before connection to fountain assembly. The furnished strainer should be installed in the supply line.
4. Connect the fountain to supply line with a shut off valve and install a 3/8" (10mm) water line between the valve and fountain. Connect the 3/8 line to the inlet of the strainer by loosening the retaining nut and inserting the tubing past the o-rings (approximately 3/4"). Finger tighten nut to lock tubing in place.
5. Stream height is factory set at 35 psi. If supply pressure varies greatly from this, turn adjustment screw on regulator. Clockwise adjustment will raise the stream and counter-clockwise adjustment will lower the stream. For best adjustments, stream should hit the basin 6-1/2" (165mm) from the bubbler.

ACTUATION OF QUICK CONNECT WATER FITTINGS

Fountain is provided with lead free connectors which utilize an o-ring water seal. To remove tubing from the fitting, relieve water pressure, push in on gray collar while pulling on the tubing. To insert tubing, push tube straight into the fitting until it reaches a positive stop (approximately 3/4" [19mm]). See Fig. 1.

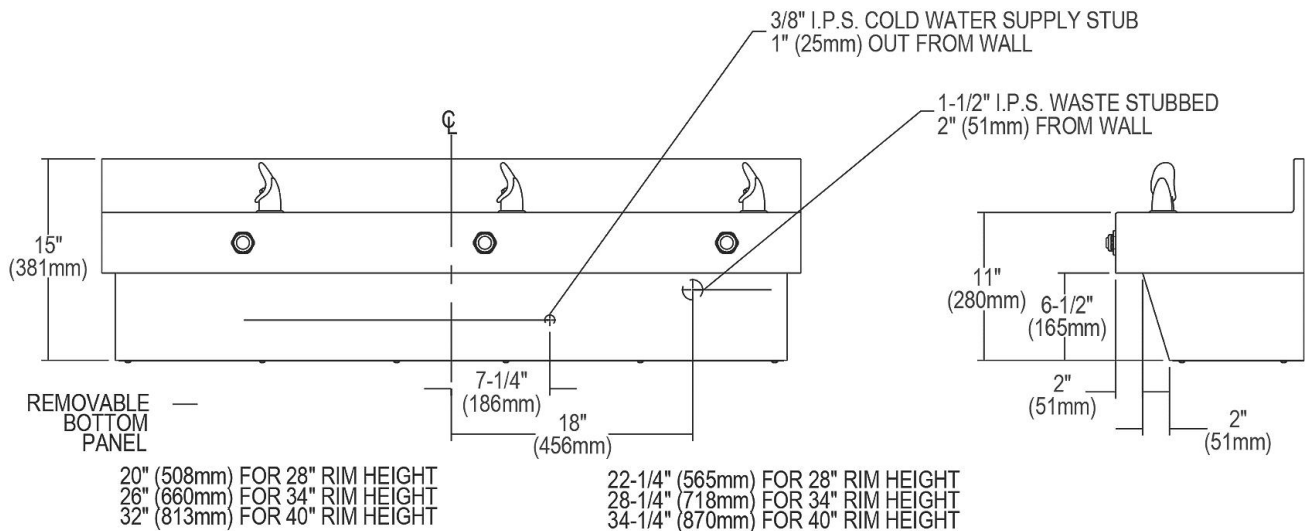

OPERATION OF QUICK CONNECT FITTINGS

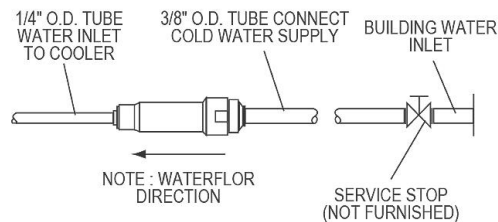
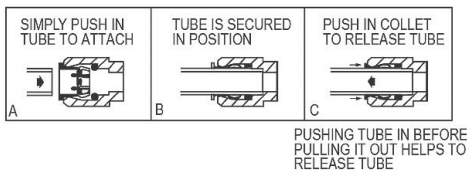

In keeping with our policy of continuing product improvement, Elkay reserves the right to change product specifications without notice. Please visit elkay.com for the most current version of Elkay product specification sheets. This specification describes an Elkay product with design, quality, and functional benefits to the user. When making a comparison of other producers' offerings, be certain these features are not overlooked.