

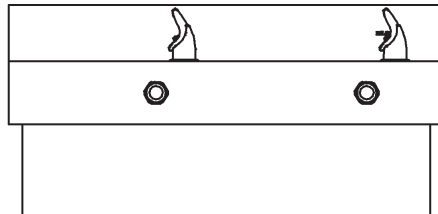

EDF210C & EDF310C Series Fountains

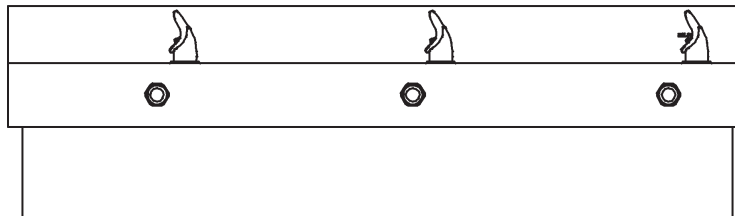

EDF210C TWO STATION FOUNTAIN



EDF310C THREE STATION FOUNTAIN

IMPORTANT

ALL SERVICE TO BE PERFORMED BY AN AUTHORIZED SERVICE PERSON

IMPORTANT! INSTALLER PLEASE NOTE.

THE GROUNDING OF ELECTRICAL EQUIPMENT SUCH AS TELEPHONE, COMPUTERS, ETC. TO WATER LINES IS A COMMON PROCEDURE. THIS GROUNDING MAY BE IN THE BUILDING OR MAY OCCUR AWAY FROM THE BUILDING. THIS GROUNDING CAN CAUSE ELECTRICAL FEEDBACK INTO A FOUNTAIN, CREATING AN ELECTROLYSIS WHICH CAUSES A METALLIC TASTE OR AN INCREASE IN THE METAL CONTENT OF THE WATER. THIS CONDITION IS AVOIDABLE BY USING THE PROPER MATERIALS AS INDICATED. ANY DRAIN FITTINGS PROVIDED BY THE INSTALLER SHOULD BE MADE OF PLASTIC TO ELECTRICALLY ISOLATE THE FOUNTAIN FROM THE BUILDING PLUMBING SYSTEM.

INSTALLATION INSTRUCTIONS

1. Familiarize yourself with the components of the drinking fountain.
2. Determine location of rough-in and plumbing connections. Mount hanger bracket(s) to wall at desired height.
3. Install fountain to wall. Install additional fasteners to bolt fountain securely to wall.
4. Connect strainer to water supply (service stop). Refer to figure 5. **DO NOT SOLDER TUBES INSERTED INTO THE STRAINER AS DAMAGE TO THE O-RINGS MAY RESULT.** Connect trap to waste stub and fountain.
5. Turn on water supply and check for leaks at all plumbing and drain connections. Fix all leaks as required.

**ROUGH - IN DIMENSIONS
EDF210C (TWO STATION)**

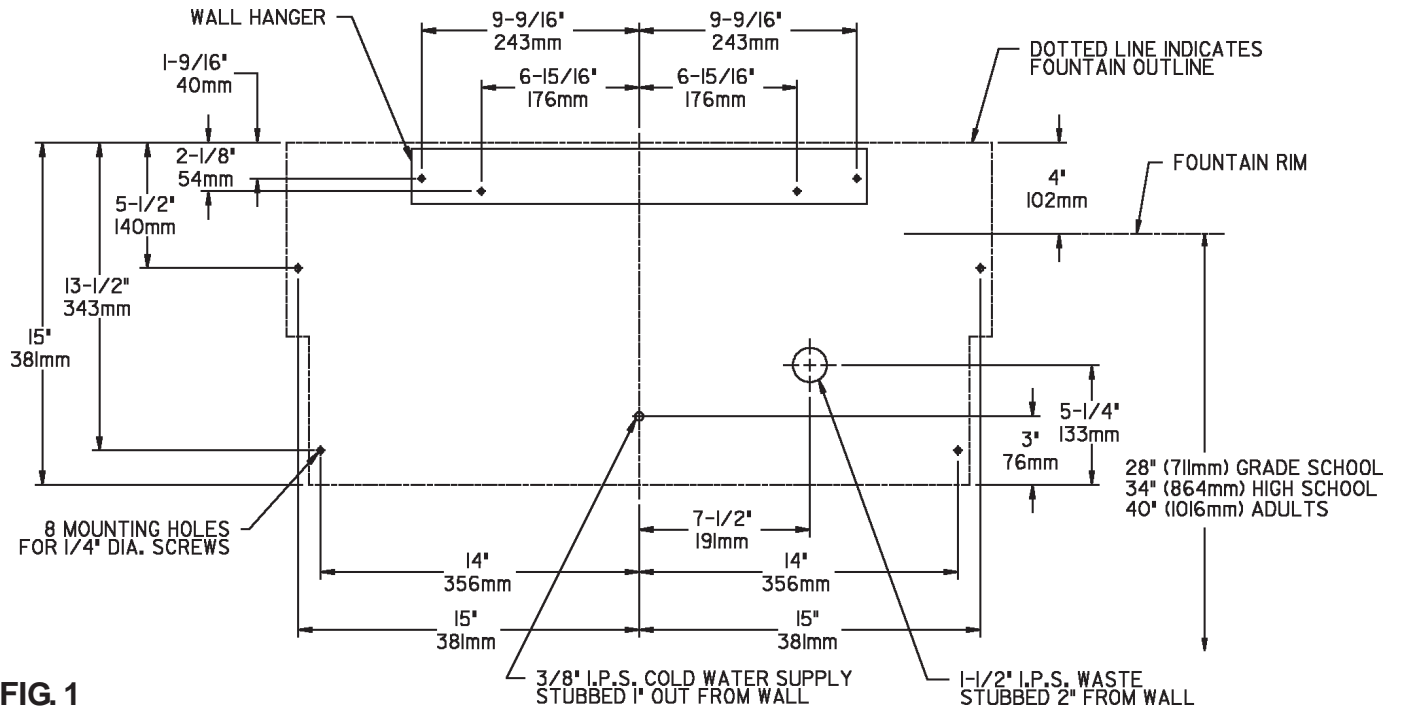

FIG. 1

**ROUGH - IN DIMENSIONS
EDF310C (THREE STATION)**

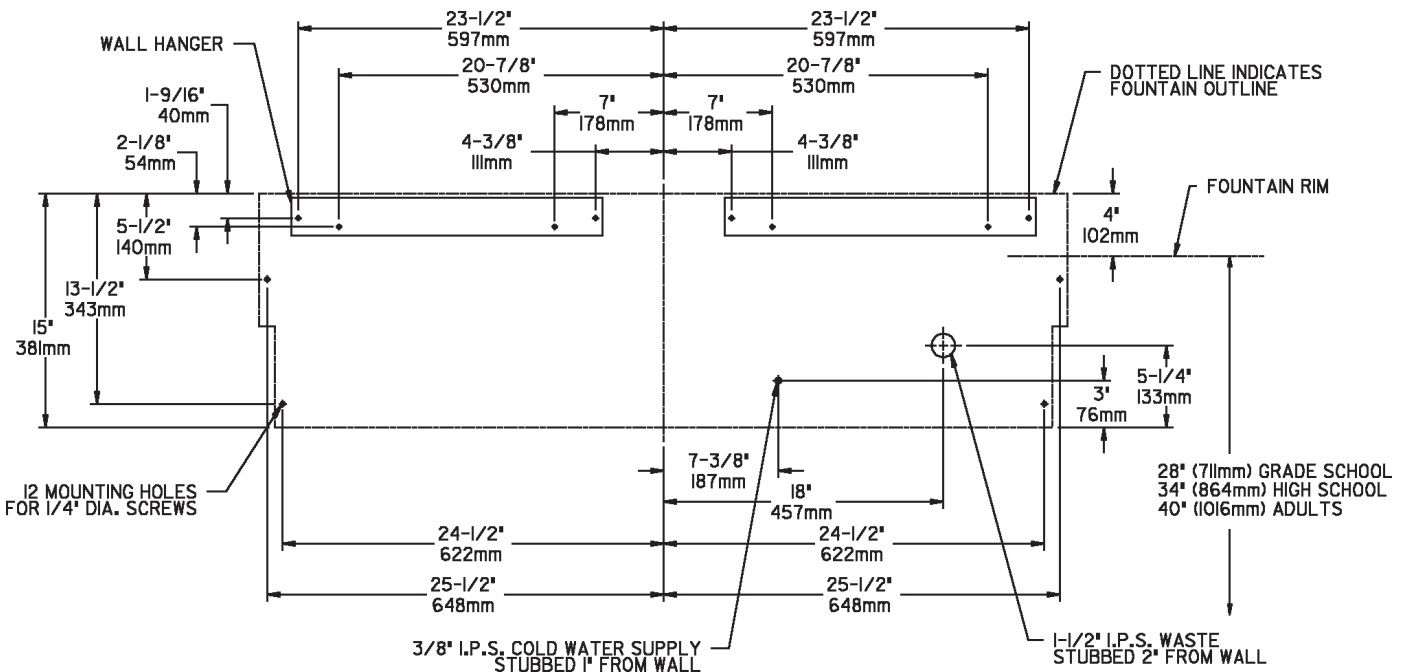
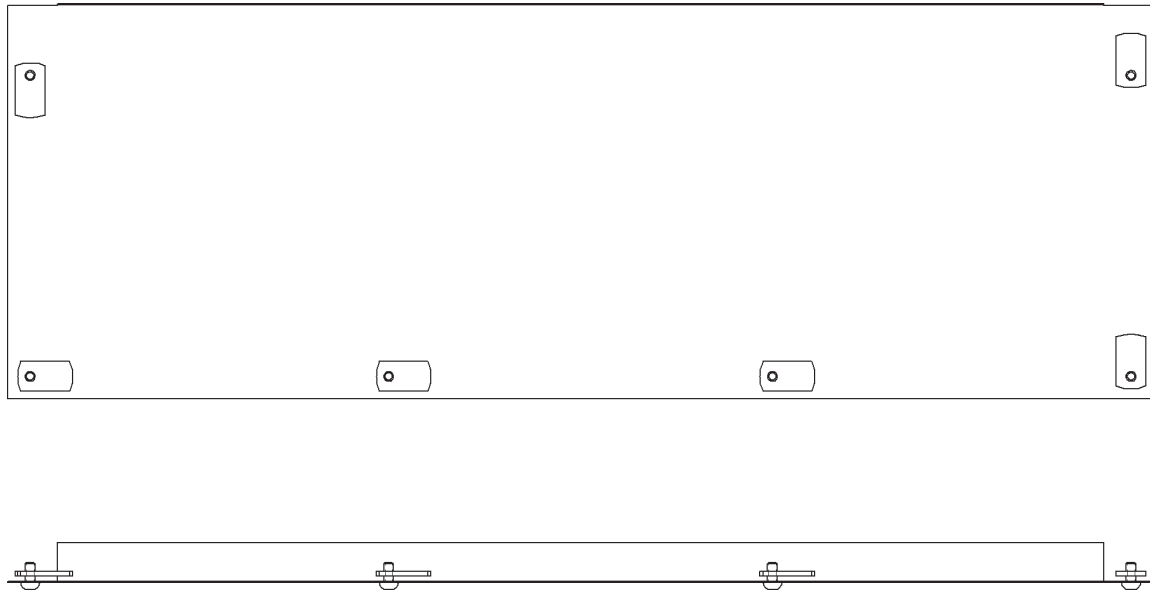

FIG. 2



HOW TO ATTACH COVER PLATE

STEP 1.

POSITION WELD NUTS AND SCREWS AS SHOWN IN THE ABOVE PICTURE.

STEP 2.

POSITION PLATE TO BOTTOM OF FOUNTAIN KEEPING EQUAL MARGIN ON EACH SIDE.

STEP 3.

TIGHTEN SCREWS - AS SCREWS ARE DRAWN UP THE WING OF THE WELD NUT WILL SANDWICH THE FLANGE OF THE FOUNTAIN.

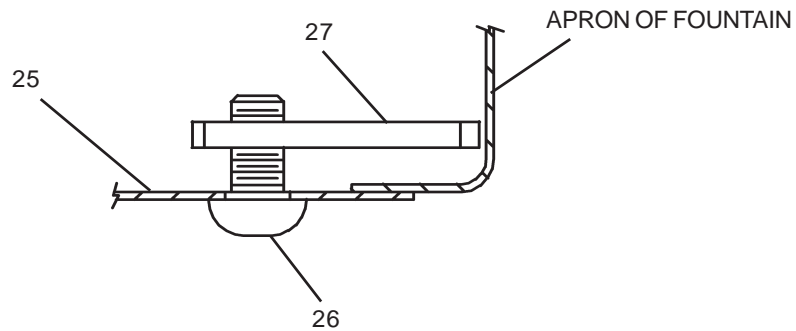

ITEMIZED PARTS LIST

| ITEM NO. | PART NO. | DESCRIPTION |
|----------|----------|------------------------------|
| 1 | 56073C | Bubbler Assy. |
| 2 | 40169C | Hex Nut |
| 3 | 40048C | Button |
| 4 | 40089C | Cover |
| 5 | 40322C | Orifice Assy. |
| 6 | 56011C | Bubbler Housing |
| 7 | 55997C | Pedestal |
| 8 | 61313C | Regulator |
| 9 | 75580C | Locking Nut |
| 10 | 45336C | Strainer/Ferrule Assy. |
| 11 | 50074C | Gasket - Tailpipe |
| 12 | 28568C | Fountain |
| 13 | 55996C | Strainer |
| 14 | 56092C | Polytubing |
| 15 | 70682C | Tee - 1/4 |
| 16 | 45852C | Trap Assy. |
| 17 | 45853C | Wasteline Tee Assy. |
| 18 | 45854C | Tailpipe |
| 19 | 15005C | Regulator Retaining Nut |
| 20 | 28580C | Hanger Bracket |
| 21 | 50986C | Regulator Holder |
| 22 | 45855C | Wasteline |
| 23 | ---- | ---- |
| 24 | ---- | ---- |
| 25 | 28332C | Bottom Cover Plate |
| 26 | 75701C | Machine Screw 1/4-20 x 1/2 |
| 27 | 75700C | Weld Nut 1/4-20 x 1 1/4 Long |

FIG. 3

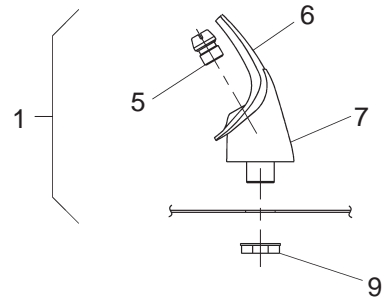

1 - SEE FIG. 3

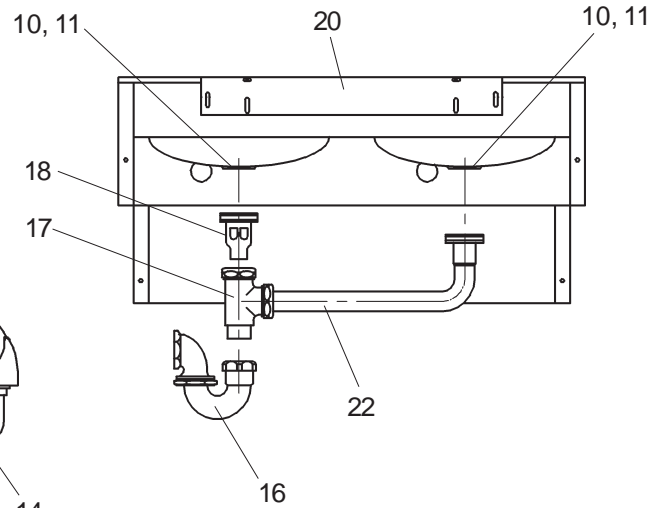
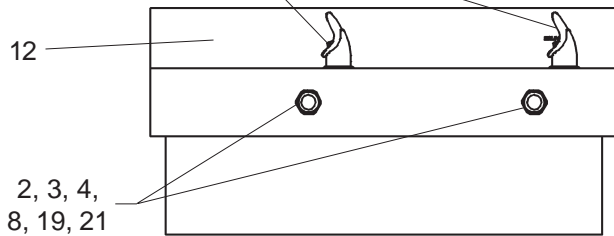

FIG. 4

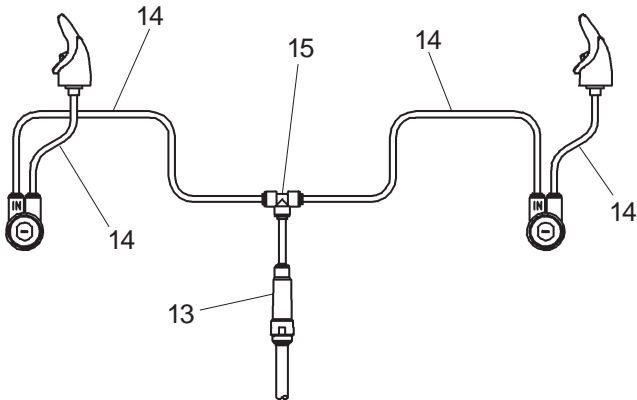
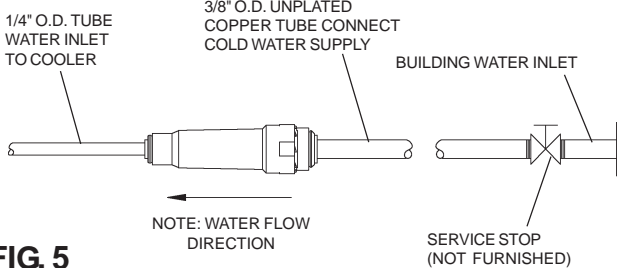

FIG. 5



OPERATION OF QUICK CONNECT FITTINGS

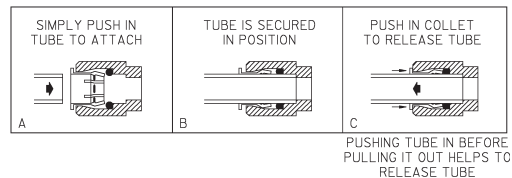

FIG. 6

