



model 3601

Modular Outdoor Drinking Fountain

FEATURES & BENEFITS

DRAIN CLEAN-OUT

Top-down access to the drain allows the fountain portion to be cleaned without taking the unit apart, good for outdoor settings with drain-clogging sediment such as leaves, garbage, and other debris.

BARRIER-FREE

Barrier-free capabilities combined with its ease of use allows for a number of installation location possibilities.

BUBBLER HEAD

Polished chrome-plated brass bubbler head with integral basin shank for added strength. Shielded, angled stream opening provides a steady, sanitary source of drinking water at .45 gpm.

PUSH BUTTON VALVE

The push-button activated valve offers the 'only' all stainless steel valve body that is machined out of solid bar stock, is fully serviceable through the front of the push button assembly offering access to the water control cartridge and integral water supply strainer, and with front access to the water stream height adjustment for easy maintenance without having to remove the valve. Operating pressure range of 30 to 90 psi (2.1 to 6.2 bar).

MODULAR CONFIGURATION

Bottle filler, drinking fountain, dog bowl and/or hose bib can be re-positioned, added or removed on site at any time. Side arm(s) can be placed high or low within its opening, and valve button position can be placed in any direction.

OPTIONS

- ❑ Modular Outdoor Pedestal Hose Bib: Model 3661, panel mounted compression hose bib faucet for the 3600 series modular outdoor pedestals. Available in three standard colors - order 3661-01 silver, 3661-02 blue, and 3661-03 green.
- ❑ Modular Outdoor Pedestal Lockable Bib Faucet: Model 3660, compression hose bib faucet housed in a lockable compartment for the Haws 3600 series modular outdoor pedestals. Available in three standard colors - order 3660-01 silver, 3660-02 blue, and 3660-03 green.
- ❑ Modular Outdoor Bottle Filler Dog Bowl: Model 3670, dog bowl for the Haws 3600 series modular outdoor pedestals. Available in three standard colors - order 3670-01 silver, 3670-02 blue, and 3670-03 green.
- ❑ Bottle Filler, ODBF: Model 3690, bottle filler for the Haws 3600 series modular outdoor pedestals. Available in three standard colors - order 3690-01 silver, 3690-02 blue, and 3690-03 green.

For more information, visit www.hawsc.com or call (888) 640-4297.



STANDARD
COLOR OPTIONS

Silver - 01 shown



Blue - 02



Green - 03

SPECIFICATIONS

Model 3601 modular outdoor, barrier-free pedestal drinking fountain shall include a 3/16" phosphated-steel pedestal with silver powder-coating, push-button operated stainless steel valve with front-accessible cartridge and flow adjustment, polished chrome-plated brass vandal-resistant shielded bubbler head, polished chrome-plated vandal-resistant waste strainer with top-down clean-out access, 100% lead-free waterways, vandal-resistant access plates, integral mounting feet, and 1-1/2" slip waste.

APPLICATIONS

The 3601 offers a solution for the changing needs of outdoor settings as well as outdoor wheelchair access, appealing to all users through accessibility and safety. This outdoor fountain is ideal in areas such as parks, schools, and other outdoor areas where hydration facilities are needed. Model meets all current Federal Regulations for the disabled including those in the Americans with Disabilities Act, and complies with Prop 65. Certified by CSA to NSF/ANSI 61, section 9 and NSF/ANSI 372; and was evaluated to be compliant to US and Canada Plumbing Codes including Uniform Plumbing Code (UPC), International Plumbing Code (IPC) and National Plumbing Code of Canada (NPC).



NOTE: IT IS RECOMMENDED TO REFERENCE THE LATEST ICC A117.1 ACCESSIBLE AND USABLE BUILDINGS AND FACILITIES / DEPARTMENT OF JUSTICE ADA STANDARDS FOR ACCESSIBLE DESIGN TO ENSURE COMPLIANCE.

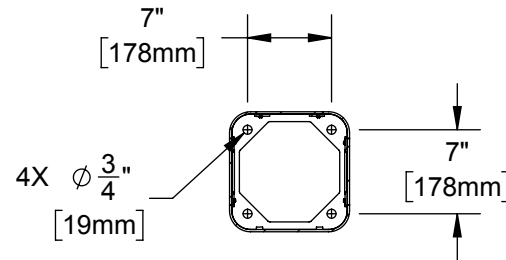
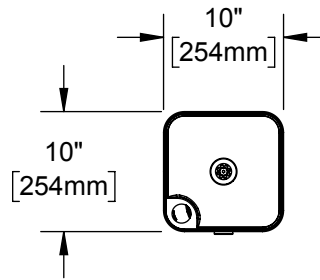

**SECTION A-A
INTERNAL PEDESTAL MOUNTING DETAIL**

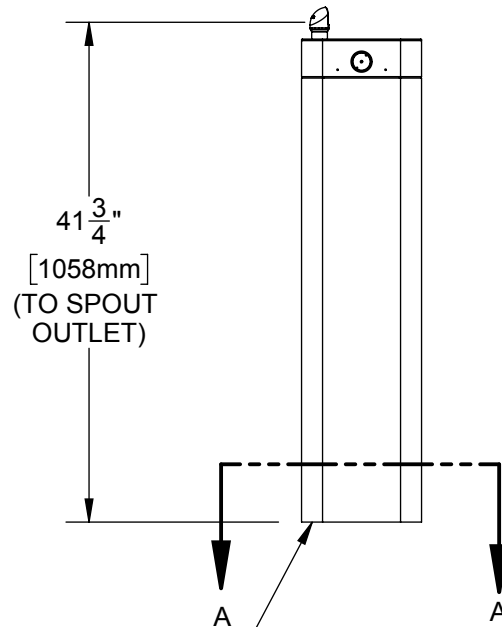

CONCRETE ANCHORS TO BE USED FOR MOUNTING 4X 5/8"-11 UNC

			1455 KLEPPE LANE SPARKS, NEVADA 89431 (775) 359-4712 FAX (775) 359-7424 E-MAIL: HAWS@HAWSO.COM WEBSITE: WWW.HAWSO.COM		
			ECN: 5226 DRAWN: MH APPROVED: IR	REV. ECN: 5399 DATE: 03/06/17 DATE: 02/19/19	BY: MJ CHKD: MH
SCALE: 1:16			DRAWING TYPE: INSTALLATION		SIZE: A
SHEET 1 OF 1					