

PRODUCT SPECIFICATIONS

Elkay Wall Mount Fully Recessed Cuspidor Non-Filtered, Non-Refrigerated Stainless. Product shall be Recessed Mount, for Indoor + Outdoor applications, serving 1 station(s).

Finish:	Stainless Steel
Power:	No Electrical Required
Bubbler Style:	No Bubbler
Mounting Type:	Recessed Mount
Chilling Capacity:	Non-refrigerated
Dimensions (L x W x H):	19" x 11-3/16" x 32-1/2"
Approx. Shipping Weight:	29 lbs.
Installation Location:	Indoor + Outdoor
No. of Stations Served:	1

**When used in non-temperature controlled environments, unit(s) must be adequately winterized and/or protected from extreme heat to prevent damage where climates dictate.



Included with Product: Cuspidor
Ships in one box.

AMERICAN PRIDE. A LIFETIME TRADITION. Like your family, the Elkay family has values and traditions that endure. For almost a century, Elkay has been a family-owned and operated company, providing thousands of jobs that support our families and communities.



PRODUCT COMPLIANCE

ASME A112.19.3/CSA B45.4

Buy American Act



[Installation Instructions \(PDF\)](#)

Water Systems are warranted for 12 months from date of installation. **Warranty pertains to drinking water applications only. Non-drinking water applications are not covered under warranty.**

[Warranty \(PDF\)](#)

PART: _____ QTY: _____

PROJECT: _____

CONTACT: _____

DATE: _____

NOTES: _____

APPROVAL: _____

In keeping with our policy of continuing product improvement, Elkay reserves the right to change product specifications without notice. Please visit elkay.com for the most current version of Elkay product specification sheets. This specification describes an Elkay product with design, quality, and functional benefits to the user. When making a comparison of other producers' offerings, be certain these features are not overlooked.

Optional Accessories

<p>AP99</p>	<p>Elkay Access Panel 9" x 9" x 6" Spec Sheet (PDF)</p>
-----------------------------	---



INSTALLER NOTE
This drinking fountain is furnished with a bubbler and valve including all connecting fittings which are manufactured of completely lead free material. Shut off valve (not furnished) to accept 3/8" O.D. unplated copper tube.

OPERATION OF QUICK CONNECT FITTINGS

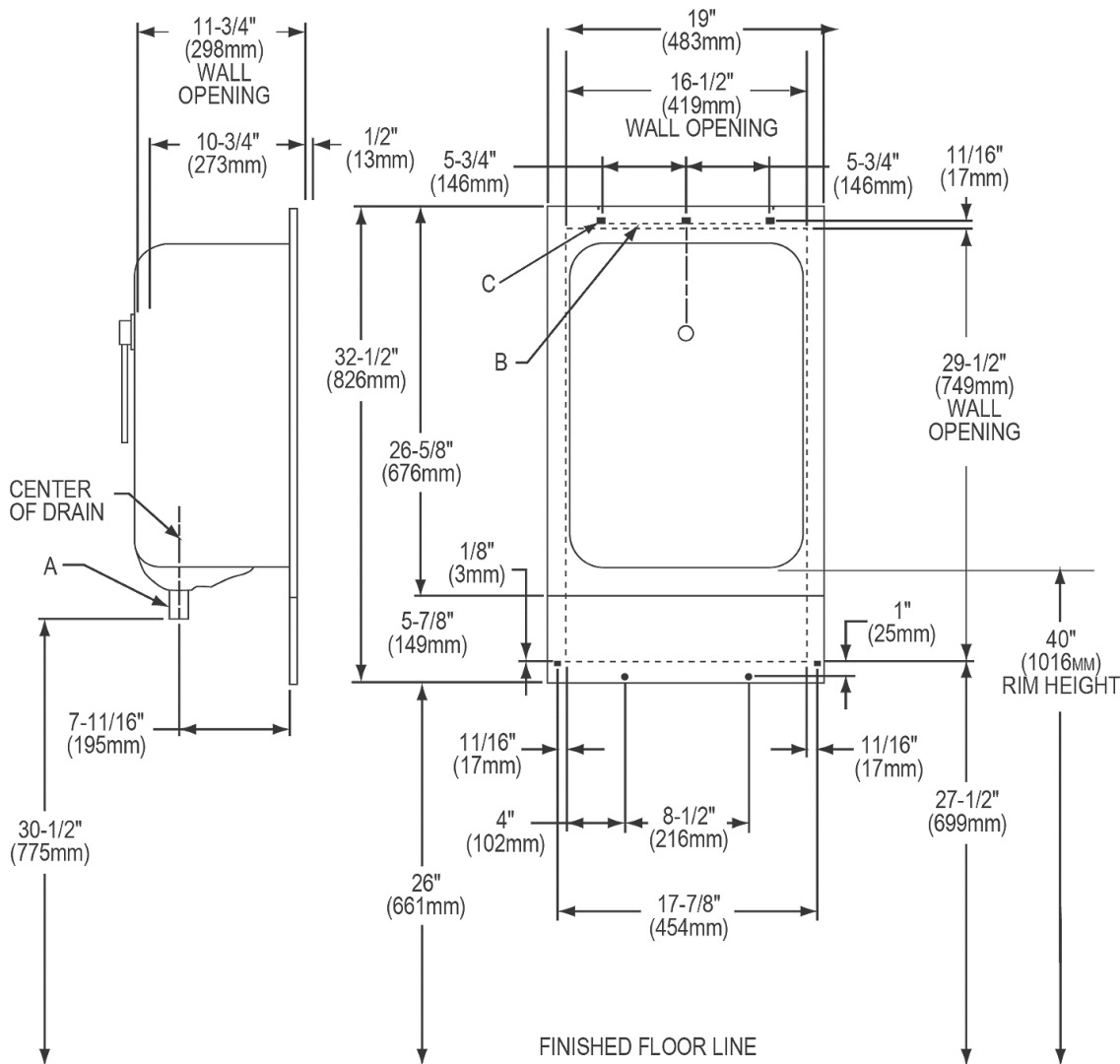
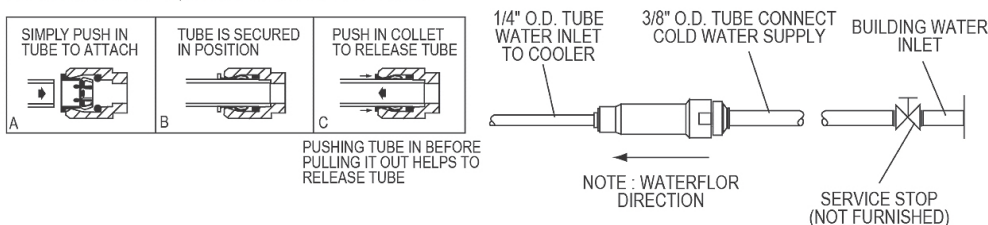

LEGEND FOR LEFT FOUNTAIN:
A = Cuspidor waste outlet location.
1-1/4" (32mm) O.D. drain (trap not furnished).
B = Wall hanger - 12" (305mm) x 1" (25mm) furnished loose.
C = Mounting holes for 1/4" Ø (6mm) screws.

In keeping with our policy of continuing product improvement, Elkay reserves the right to change product specifications without notice. Please visit elkay.com for the most current version of Elkay product specification sheets. This specification describes an Elkay product with design, quality, and functional benefits to the user. When making a comparison of other producers' offerings, be certain these features are not overlooked.