

ELKAY® SPECIFICATIONS

Weldbilt® Single Compartment Scullery Sink 1/4-Inch Radius Coved Corner

GENERAL

Model No. WNSF _____ #14 gauge, type 304, (18-8) stainless steel scullery sink. Compartments 14" deep. Welded 1/4" radius coved corner construction. Welds are ground to a smooth and cleanable finish. Full length 8" high backsplash with 45° sloped top. 1-1/2" wide inward sloping top channel rims. Integral drainboard/s, sink compartments pitched to drain. Exposed surfaces polished to a satin finish. Weldbilt sinks carry the NSF International Certification.

Sinks supported on (4) **LK251** stainless steel, 1-5/8" O.D. tubular legs, #16 gauge wall thickness. Adjustable bullet shaped feet.

Shaded models are normally carried in stock with standard faucet location.

Non-shaded models with specified dimensions are considered standard models which must be made to order—standard faucet location unless otherwise specified.

Last item in each group is custom. Fill in dimensions. Standard faucet location unless otherwise specified.

Drainboards over 25-1/2" long furnished with one tubular leg.

Drainboards over 48" long furnished with two tubular legs.

SPECIFIED FITTINGS:

SUPPLY:

DRAIN:

ALL DIMENSIONS IN INCHES.

SEE OTHER SIDE FOR DIMENSIONS IN MILLIMETERS.

(Check Model Specified):

NO DRAINBOARD

| Model Number | Dimensions | |
|--------------|------------|----|
| | A | B |
| WNSF8124 | 27 | 24 |
| WNSF8130 | 33 | 30 |
| WNSF8136 | 39 | 36 |
| • WCNSF8100 | | |

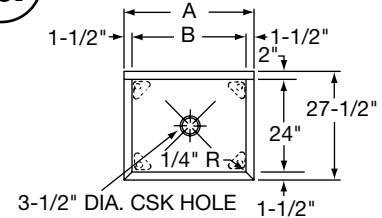

RIGHT DRAINBOARD

| Model Number | Dimensions | | |
|--------------|------------|----|----|
| | A | B | C |
| WNSF8124R | 49 1/2 | 24 | 24 |
| WNSF8130R | 55 1/2 | 30 | 24 |
| WNSF8136R | 61 1/2 | 36 | 24 |
| • WCNSF8100R | | | |

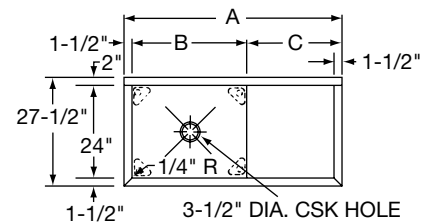

LEFT DRAINBOARD

| Model Number | Dimensions | | |
|--------------|------------|----|----|
| | A | B | C |
| WNSF8124L | 49 1/2 | 24 | 24 |
| WNSF8130L | 55 1/2 | 30 | 24 |
| WNSF8136L | 61 1/2 | 36 | 24 |
| • WCNSF8100L | | | |

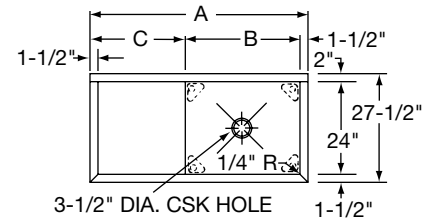

RIGHT & LEFT DRAINBOARD

| Model Number | Dimensions | | |
|---------------|------------|----|----|
| | A | B | C |
| WNSF8124LR | 72 | 24 | 24 |
| WNSF8130LR | 78 | 30 | 24 |
| WNSF8136LR | 84 | 36 | 24 |
| • WCNSF8100LR | | | |

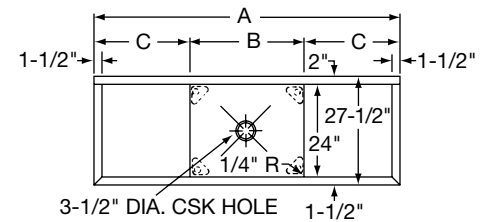

INDICATE NUMBER OF FAUCET HOLES WHEN PLACING ORDER. (NON-STANDARD FAUCET AND OVERFLOW DRILLING LOCATIONS ARE AVAILABLE. SPECIFY ON DRAWING AT RIGHT.)

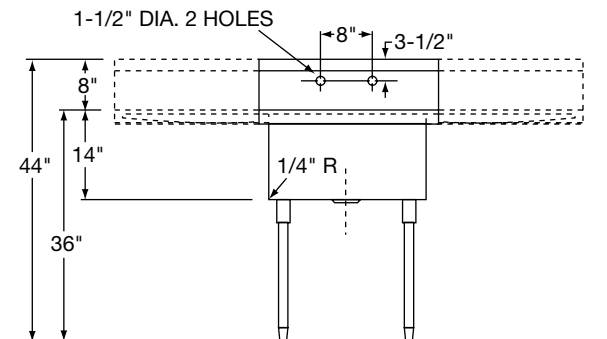

Weldbilt® Single Compartment Scullery Sink 6mm Radius Coved Corner

ELKAY® SPECIFICATIONS

GENERAL

Model No. WNSF_____ #14 gauge, type 304, (18-8) stainless steel scullery sink. Compartments 356mm deep. Welded 6mm radius coved corner construction. Welds are ground to a smooth and cleanable finish. Full length 203mm high backsplash with 45° sloped top. 38mm wide inward sloping top channel rims. Integral drainboard/s, sink compartments pitched to drain. Exposed surfaces polished to a satin finish. Weldbilt sinks carry the NSF International Certification.

Sinks supported on (4) **LK251** stainless steel, 41mm O.D. tubular legs, #16 gauge wall thickness. Adjustable bullet shaped feet.

Shaded models are normally carried in stock with standard faucet location.

Non-shaded models with specified dimensions are considered standard models which must be made to order—standard faucet location unless otherwise specified.

Last item in each group is custom. Fill in dimensions. Standard faucet location unless otherwise specified.

Drainboards over 648mm long furnished with one tubular leg.

Drainboards over 1,219mm long furnished with two tubular legs.

SPECIFIED FITTINGS:

SUPPLY:

DRAIN:

ALL DIMENSIONS IN MILLIMETERS.
SEE OTHER SIDE FOR DIMENSIONS IN INCHES.

(Check Model Specified):

NO DRAINBOARD

| Model Number | Dimensions | |
|--------------|------------|-----|
| | A | B |
| WNSF8124 | 686 | 610 |
| WNSF8130 | 838 | 762 |
| WNSF8136 | 991 | 914 |
| • WCNSF8100 | | |

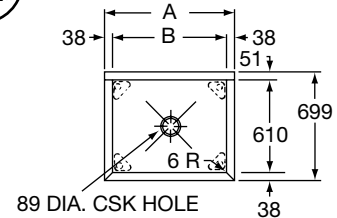

RIGHT DRAINBOARD

| Model Number | Dimensions | | |
|--------------|------------|-----|-----|
| | A | B | C |
| WNSF8124R | 1257 | 610 | 610 |
| WNSF8130R | 1410 | 762 | 610 |
| WNSF8136R | 1562 | 914 | 610 |
| • WCNSF8100R | | | |

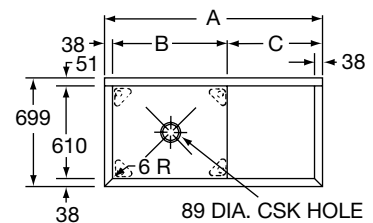

LEFT DRAINBOARD

| Model Number | Dimensions | | |
|--------------|------------|-----|-----|
| | A | B | C |
| WNSF8124L | 1257 | 610 | 610 |
| WNSF8130L | 1410 | 762 | 610 |
| WNSF8136L | 1562 | 914 | 610 |
| • WCNSF8100L | | | |

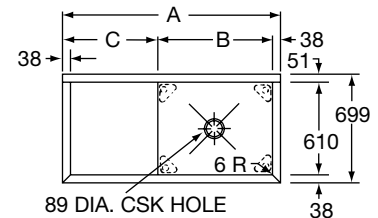

RIGHT & LEFT DRAINBOARD

| Model Number | Dimensions | | |
|---------------|------------|-----|-----|
| | A | B | C |
| WNSF8124LR | 1829 | 610 | 610 |
| WNSF8130LR | 1981 | 762 | 610 |
| WNSF8136LR | 2134 | 914 | 610 |
| • WCNSF8100LR | | | |

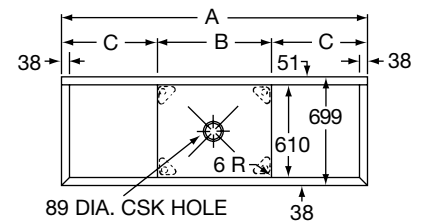

INDICATE NUMBER OF FAUCET HOLES WHEN PLACING ORDER. (NON-STANDARD FAUCET AND OVERFLOW DRILLING LOCATIONS ARE AVAILABLE. SPECIFY ON DRAWING AT RIGHT.)

