



# model 1107L

## Wall-Mounted Drinking Fountain

### FEATURES & BENEFITS

#### CONSTRUCTION

Heavy-duty 14 gauge Type 304 Stainless Steel construction with integral 1/4" (.6 cm) mounting plates for extra durability. Unit also includes vandal-resistant bottom plates for added peace-of-mind.

#### BUBBLER HEAD

Polished chrome-plated brass bubbler head features an integral basin shank for added strength, and is equipped with a shielded, anti-squirt orifice that provides a steady sanitary source of water.

#### INTEGRATED TRAP

Spacious fountain design allows for the trap to be internally mounted which allows for easy access, and aids and reduces the installation process.

#### QUALITY CONTROL

Fountain is pre-built and fully water and pressure tested to ensure no leaks and proper function for reduced installation time and added peace of mind.

#### ACCESS

Low profile designed bowl and integral trap that is set back for knee clearance allows for adult or child ADA access (when installed at appropriate heights).

#### PUSH BUTTON

With its patented (Pat. # 6,981,692) stainless steel, push-button activated valve assembly which allows for front access stream adjustment as well as cartridge and strainer access, this fountain offers 100% lead free waterways. The valve works at an operating pressure range of 30 to 90 psi (2.1 to 6.2 bar).



### SPECIFICATIONS

Model 1107L wall mounted barrier-free drinking fountain shall include a 14 gauge Type 304 Stainless Steel satin finish basin with integral 1/4" (.6 cm) stainless steel mounting plate. Push-button operated stainless steel valve with front-accessible cartridge and flow adjustment provides 100% lead free waterways, polished chrome-plated brass vandal-resistant bubbler head, polished chrome-plated brass vandal-resistant waste strainer, vandal-resistant bottom plate, and a 1-1/4" IPS internal trap. Unit can be mounted to meet ADA or Child ADA specifications.

### OPTIONS

- ❑ Filter: Model 6426, 12" x 2" (30.5 x 5.1 cm), in-line lead removal element that reduces lead from incoming water supply.
- ❑ Mounting: Model 6700 universal mounting plate for most wall mounted fountains.
- ❑ Support Carrier: Model 6800 universal in-wall mounting support for use with most fountains.
- ❑ Back Panel: Model BP7, satin finish, stainless steel back panel for Model 1107L.

To see all options for this model, visit [www.hawesco.com](http://www.hawesco.com)

### APPLICATIONS

Perfect for either public or private indoor/outdoor settings, the 1107L is a great fit in areas where aesthetics are important to the overall appeal of the architecture. This series is precisely mounted, making it a nice addition to any surrounding. Beautiful satin finish helps to maintain the fountains overall appeal so it always remains looking as new as it did when it was installed. Specifically, this type of wall mounted drinking fountain may be placed in settings such as: schools and other locations in and around office buildings where the temperature remains above freezing.

Model meets all current Federal Regulations for the disabled including those in the Americans with Disabilities Act. Haws manufactures drinking fountains and electric water coolers to be lead-free by all known definitions including NSF/ANSI Standard 61, Section 9, California Proposition 65, and the Federal Safe Drinking Water Act. Product is compliant to California Health and Safety Code 116875 (AB 1953-2006).



**NOTES:**

1. HOLD ROUGH-IN DIMENSIONS ± 1/4" (6.4mm)
2. WHEN INSTALLING THIS UNIT, LOCAL STATE OR FEDERAL CODES SHOULD BE ADHERED TO. FOR INSTALLATION HEIGHTS OTHER THAN SHOWN, DIMENSIONS MARKED (\*) MUST BE ADJUSTED ACCORDINGLY.
3. REFER TO 5874/ARKS874 OPERATION AND MAINTENANCE MANUAL FOR PUSH BUTTON AND VALVE INSTALLATION AND MAINTENANCE INSTRUCTIONS.
4. ROUGH IN DIMENSIONS FOR FOUNTAIN HEIGHTS:

CHILD WHEELCHAIR HEIGHT: SEE SHIT 2 FIG 1  
 WASTE: 26-1/4" (667mm)  
 SUPPLY: 26-1/8" (664mm)  
 MOUNTING HOLE: 24-13/16" (630mm)  
 FOUNTAIN: 23-3/16" (589mm)  
 BUBBLER: 24" (610mm)  
 BUBBLER: 29-7/8" (756mm)

ADULT WHEELCHAIR HEIGHT: SEE SHIT 2 FIG 2  
 WASTE: 29-1/4" (743mm)  
 SUPPLY: 29-1/8" (740mm)  
 MOUNTING HOLE: 27-13/16" (706mm)  
 FOUNTAIN: 26-3/16" (665mm)  
 BUBBLER: 27" (686mm)  
 BUBBLER: 32-7/8" (832mm)

STANDING ADULT HEIGHT: SEE SHIT 2 FIG 3  
 WASTE: 34-3/4" (883mm)  
 SUPPLY: 34-5/8" (879mm)  
 MOUNTING HOLE: 33-5/16" (846mm)  
 FOUNTAIN: 31-11/16" (805mm)  
 BUBBLER: 32-1/5" (826mm)  
 BUBBLER: 38-3/8" (972mm)

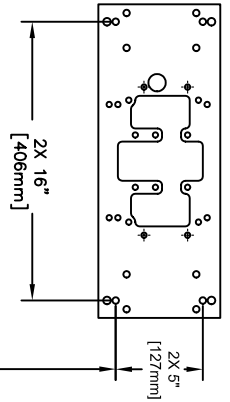

CHILD/ADULT/  
ADULT STANDING  
MOUNTING PLATE

MOUNTING PLATE  
(OPTIONAL, HAWS 6700)

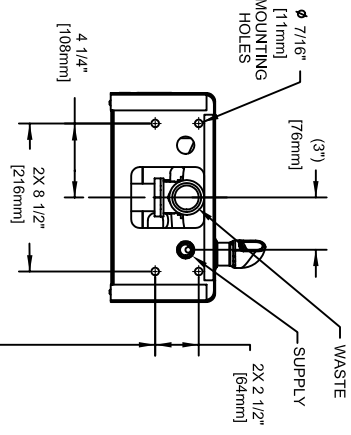
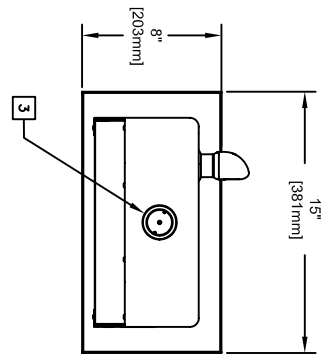

CHILD/ADULT/  
ADULT STANDING  
MOUNTING HOLE

MOUNTING DETAIL  
BACK VIEW

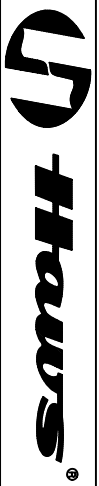
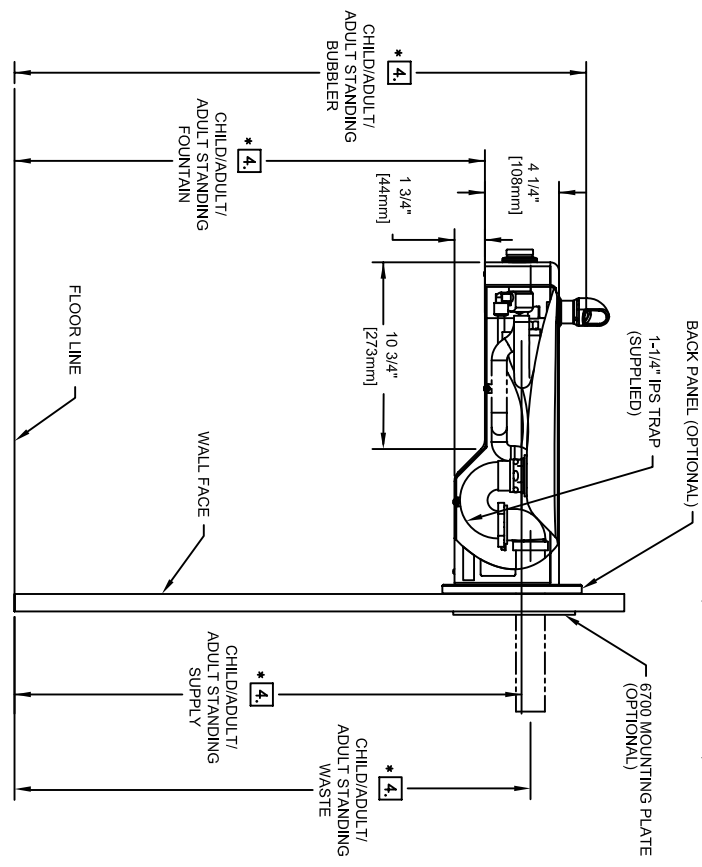
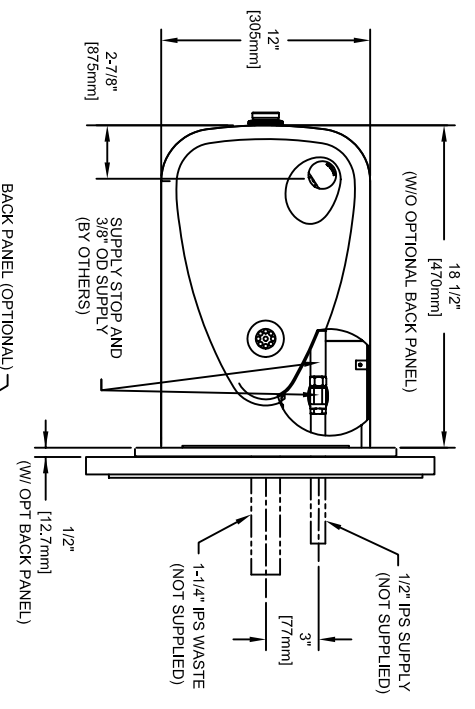

ECON NO. REVISED PER BY:	MODEL(S)	1107L
DRAWN: G. FENNER	DATE: 10/23/06	SCALE: 1:1
CHECKED: CHKCD	DATE:	DRAWING TYPE: INSTALLATION
APPROVED:	DATE:	SIZE: A
PART NUMBER		SHEET: 1 OF 1
0002080232D		
DRAWING NO. REV		
15267A00 10		

1455 KLEPPE LANE  
 SPARKS, NEVADA 89431  
 (775) 359-4712 FAX (758) 359-7424  
 E-MAIL: HAWS@HAWS.CO.COM  
 WEBSITE: WWW.HAWS.CO.COM