

FEATURES & BENEFITS

NSF/ANSI: 53 CERTIFICATION

PFOA/PFOS (PFAS)

NSF/ANSI: 401 CERTIFICATION

Microplastics (Pending)

NSF/ANSI: 53 CERTIFICATION

Lead/Cysts (Pending)

NSF/ANSI: 42 CERTIFICATION

Chlorine/Taste/Odor (Pending)

PFOA/PFOS REDUCTION

2500 Gal @ 1 GPM without PID

OPERATING TEMPERATURE

40 - 100 F

MAXIMUM OPERATING PRESSURE

125 psig

MICRON RATING

>99% @ 0.5M

FILTER MEDIA

0.5 Micron Carbon Block

FLOW RATE

1 GPM (Included Flow Restrictor Required)

CAPACITY

2,500 Gallons (9,463 L)

INSTALLATION/OPERATION/MAINTENANCE

Flush new cartridge for 10 minutes prior to use.



SPECIFICATIONS

Model 6445 PFOA/PFOS (PFAS) rated filter is an option to any Haws fountain and or bottle filler that uses the Haws 6428 filter. This 2500 gallon direct replacement filter is for any Haws hydration equipment to remove PFAS chemicals from their water, and flows at 1 gpm. If wanted for use with the Haws RIVIVE™ and Electric Water Cooler products, a simple bottle filler nozzle replacement is needed to work with the 1 gpm filter output (supplied).

APPLICATIONS

NOTE: Install in cold water applications only. This filter cartridge is specifically designed for Haws 1200 series water coolers, RIVIVE fountains and bottle fillers, 3600F series pedestal fountains, and any 1000 series wall-mounted fountains using the 6480 filter kit.

This filter has been tested according to NSF/ANSI 53 for the reduction of PFOA & PFOS. The concentration of the indicated substances in water entering the system was reduced to a concentration less than or equal to the permissible limit for water leaving the system, as specified in NSF/ANSI 53. Testing was performed under standard laboratory conditions. The contaminants or other substances removed or reduced by this water treatment device are not necessarily in all users' water. Filter performance may vary based on local water conditions.

OPTIONS

For more information, visit www.hawscow.com or call (888) 640-4297.

FILTER REPLACEMENT INSTRUCTIONS:

REQUIRED TOOLS: BIT-INSERT STYLE SCREWDRIVER, SUITABLE BITS FOR ACCESSING THE FILTER (TYPICALLY A T20 TORX, 5/16" NUT DRIVER, OR 5/32" ALLEN/HEX BIT), NOZZLE KEY (INCLUDED).

CAUTION: CUT-RESISTANT GLOVES AND SAFETY GLASSES ARE HIGHLY RECOMMENDED FOR PERFORMING THIS WORK.

1. REMOVE COVERS ON THE UNIT TO ACCESS THE FILTER. REFER TO MANUAL FOR APPLICABLE MODEL FOR MORE DETAILS.
2. WHILE NOT NECESSARY, IT IS RECOMMENDED TO TURN OFF THE WATER SUPPLY TO THE UNIT. BLEED WATER PRESSURE BY ACTIVATING THE BUBBLER OR BOTTLE FILLER.
3. REMOVE EXISTING FILTER BY TURNING CLOCKWISE (AS VIEWED FROM ABOVE) THEN PULLING DOWN.
4. INSTALL NEW FILTER BY INSERTING INTO FILTER HEAD AND GENTLY ROTATING UNTIL IT SLIPS VERTICALLY INTO PLACE, THEN ROTATE APPROXIMATELY 1/4 TURN COUNTERCLOCKWISE (AS VIEWED FROM ABOVE). IF A CIRCUIT BOARD IS PRESENT, THE SMALL LABEL/ RFID TAG ON THE BACK OF THE FILTER SHOULD FACE THE CIRCUIT BOARD WHEN INSTALLED.
5. IF A BOTTLE FILLER IS PRESENT AND INCLUDES THE NOZZLE TYPE SHOWN, REPLACE THE NOZZLE USING THE INCLUDED NOZZLE AND KEY. THIS 1.0 GPM NOZZLE ENSURES THAT THE BOTTLE FILLER FLOW RATE IS APPROPRIATE FOR THE FILTER RATING.
6. RE-OPEN THE WATER SUPPLY TO THE UNIT IF IT WAS TURNED OFF. CHECK FOR LEAKS. RUN WATER THROUGH THE UNIT FOR 10 MINUTES IN ORDER TO PROPERLY FLUSH THE FILTER. IT IS NORMAL FOR SOME CARBON PARTICLES TO FLUSH THROUGH THE SYSTEM.
7. REPLACE COVERS ON THE UNIT. IF THE UNIT DOES NOT HAVE A FILTER MONITORING SYSTEM, THEN TAKE NOTE OF THE UNIT LOCATION AND DATE OF FILTER CHANGE. MODEL 6445 FILTER SHALL BE REPLACED EVERY 1 YEAR OR 2,500 U.S. GALLONS, WHICHEVER COMES FIRST.

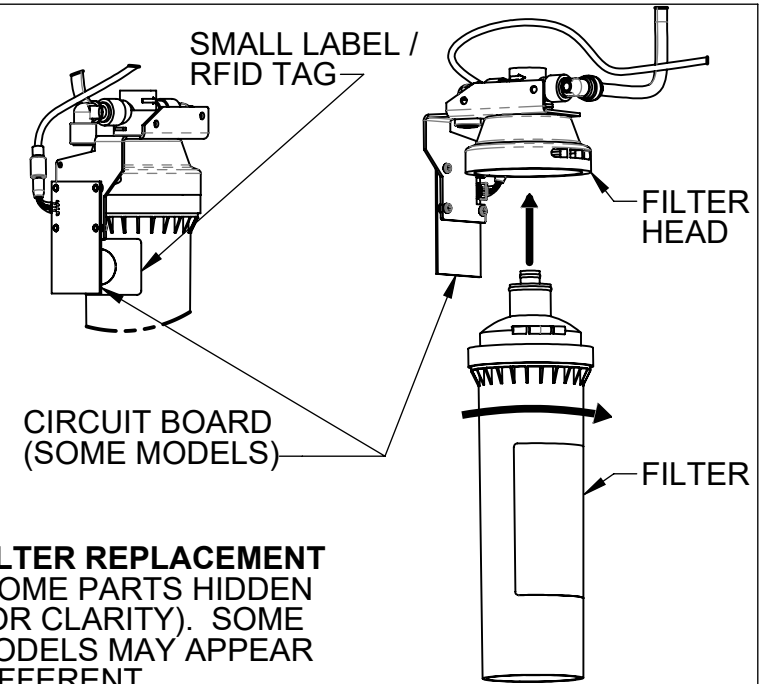

NOZZLE REPLACEMENT
(SOME PARTS HIDDEN FOR CLARITY). SOME MODELS MAY APPEAR DIFFERENT.

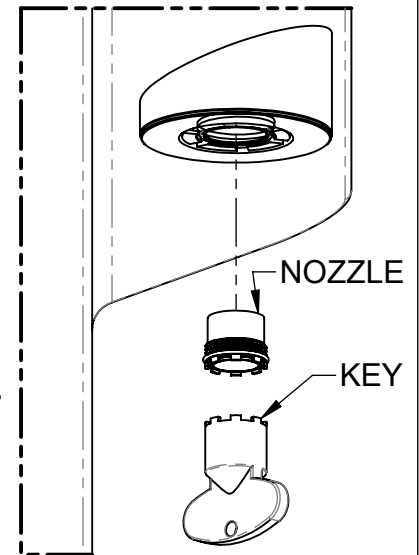

1455 KLEPPE LANE
SPARKS, NEVADA 89431
(775) 359-4712 FAX (775) 359-7424
E-MAIL: HAWS@HAWSO.COM
WEBSITE: WWW.HAWSO.COM

ECN: 6237	REV. ECN: 6237	BY: DHP	MODEL(S)	PART NUMBER
DRAWN: DHP	DATE: 08/25/25	CHKD: DHP	6445 - FILTER, PFOA / PFOS (PFAS), 0.5M	0510002304
APPROVED: TM	DATE: 06/26/25	SCALE: 1:12	DRAWING TYPE: INSTALLATION	REVISION 1
			SIZE: A	SHEET 1 OF 1