



model 8710

Outdoor Tempered Shower and Eye/Face Wash System

FEATURES & BENEFITS

QUALITY CONTROL

Fully assembled and Engineer tested product that is ready for placement and hook-up.

BLENDING SYSTEM

Safe, fully engineered thermostatic mixing valve for mixing large volumes of hot and cold water guarded with anti-scald protection and full flow cold water bypass to provide tempered water in adverse situations.

TANK SYSTEM OPTIONS

119 Gallon (450 L) Tank (Option No. 21): Stores enough hot water to provide a single 15 minute, 20 gpm (75.7 L) shower. Recovery time of up to 6 hours (Also available in ASME - Option 22). 325 Gallon (1230 L) Tank (Option No. 23): stores enough hot water to provide two 15 minute, 20 gpm (75.7 L) showers before tank recovery is required. Recovery time of up to 18 hours.

STEAM SYSTEMS

Steam Heat Exchanger (Option No. 24): Feed forward instantaneous heat exchanger. Requires 15 PSIG, max. 1300 lb./hr. steam supply.

EYE/FACE WASH

AXION® MSR eye/face wash head (patent pending) uses an inverted directional laminar flow to sweep contaminants away from the vulnerable nasal cavity.

ELECTRICAL SYSTEM OPTIONS

Haws' standard system requires 208/240 VAC single phase, 3 wire 40 amp (min.), electrical supply. NEMA 4 tank (Option 31), steam (Option 36). NEMA 7 Class I, DIV2, Group B, C, D tank (Option 32), steam (Option 38) (Class I, DIV I also available)



SPECIFICATIONS

Model 8710 heated enclosed shower and eye/face wash shall include a 5' x 9' (1.52 x 2.74 m) booth has an R-value of 11 and shall include dual spring-loaded, self-closing shower doors, equipment room door, and removable service panel. The booth is trimmed with large directional arrows, large and small universal shower/eyewash signs, fiberglass floor grate, and 3" IPS inside caulk drain. The ball valves are equipped with stainless steel ball and stems, and protected by scald and freeze bleed valves. The internal booth temperature is maintained by a natural convection 2.5kw space heater. The standard alarm system is flow switch activated, and provides local audible and visible alarms. The tempered blending system will include an integral hot water supply, whether stored or supplied by steam, and will incorporate fail-safe features like anti-scald protection and full flow cold water bypass. The electrical system requires 208/240 VAC single phase, 3 wire 40 amp minimum. There is the medically acclaimed AXION® 20 gpm (75.7 L) shower head and AXION® MSR eye/face wash head assembly (patent pending), along with 3 gpm (11.4 L) to supply the side hanging drench hose. Combination shower and eye/face wash is certified by CSA to meet the ANSI Z358.1 Standard for Emergency Eyewash and Shower Equipment.

APPLICATIONS

Perfect for Petro-chemical, bio-diesel, and ethanol processing facilities, and other remote outdoor locations where drench showers with very cold water would pose a health hazard to employees and a liability to employers, or in shower areas exposed to cold air and wind where showering with very cold water could discourage proper flushing time. Model is certified by CSA to meet the ANSI Z358.1 Standard for Emergency Eyewash and Shower Equipment.

OPTIONS

To see all options for this model, visit www.hawasco.com



REV	DESCRIPTION	DATE	BY
3	AS BUILT	3/29/2014	ASZANZ

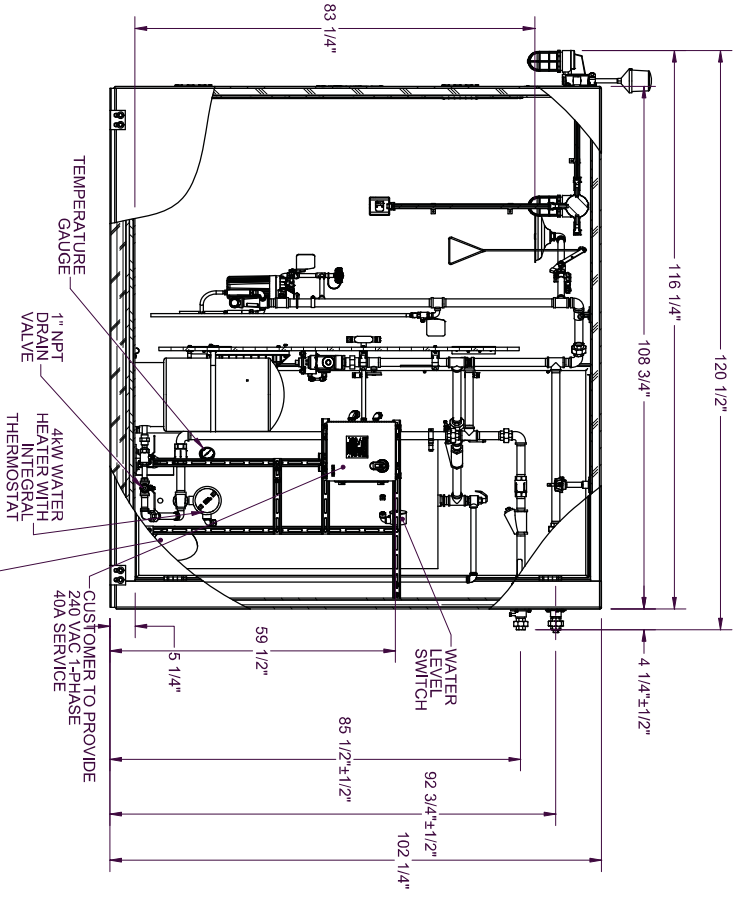
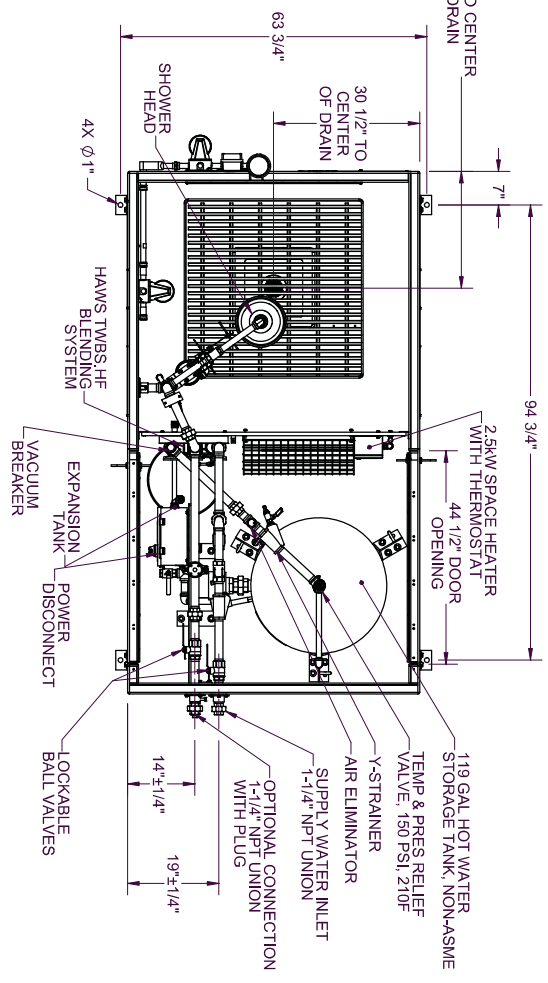
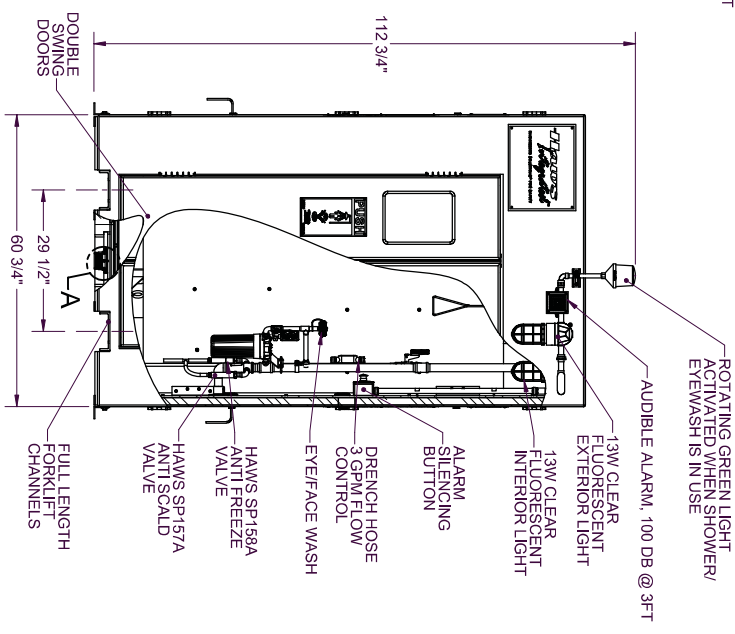
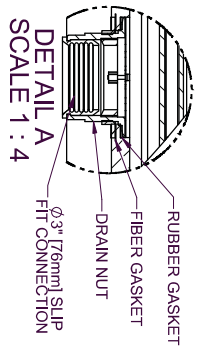
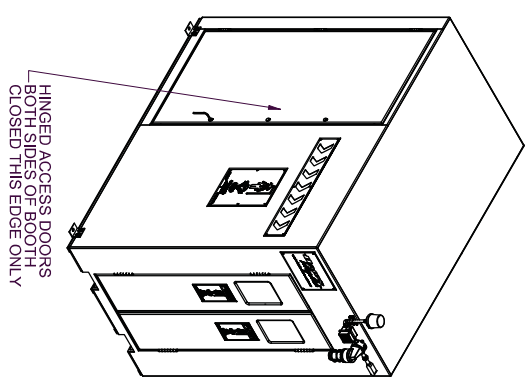

THE ATTACHED DESIGNS ARE CONSIDERED TRADE SECRETS AND POTENTIAL APPLICABLE PATENT RIGHTS ARE RESERVED. IDENTICAL OR POTENTIALLY SIMILAR DESIGNS DISCLOSED IN ANY MANNER AND CONCEPTUAL FORMS CANNOT BE DISCLOSED, REPRODUCED OR USED WITHOUT HAWS EXPRESS WRITTEN CONSENT.

APPROVALS	DATE
ASZANZ	12/9/13
DIS. RESULT	12/9/13
PROJECT ENGINEER	12/9/13

CUSTOMER NO. 186247862

PROJECT NAME: TEMPERING BOOTH W/SHOWER-EYEWASH 8710.21.31

SCALE: SEE PART NO. 1062-075062-1

NOTE OF PROPRIETARY INFORMATION: THIS DOCUMENT IS THE PROPERTY OF HAWS CORPORATION. IT IS TO BE USED ONLY FOR THE PROJECT AND NOT BE REPRODUCED OR DISCLOSED IN ANY MANNER WITHOUT THE WRITTEN CONSENT OF HAWS CORPORATION.

THIRD ANGLE PROJECTION

SCALE: SEE PART NO. 1062-075062-1

HAWS CORPORATION

1465 KLEPPLE LANE

SPARKS, NEVADA 89411