

# **NNEBFPG**

# **NNFEBFPG**

Cooler to Bottle Filler Conversion Kit for OASIS PG8AC  
Coolers

## **INSTALLATION INSTRUCTIONS**

## Section 1: Getting Started

### What's Included:

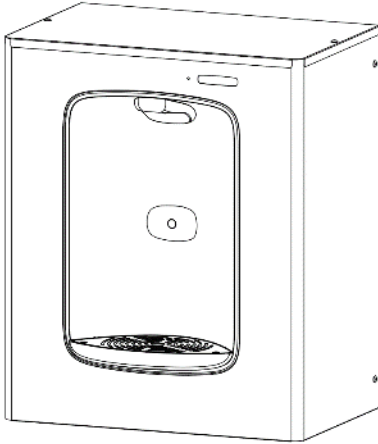

Assembled  
NN(F)EBFPG Cabinet



Drain Elbow  
x2

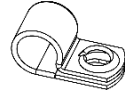

Strain Relief  
P-Clip



Installation  
instructions



T15 Torx Screws  
x13



Side Mounting  
Bracket  
x2

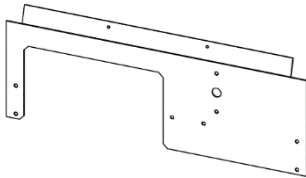

Center Bracket



#8 Hex Screw



Drainpipe  
x2

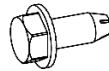

#8 Thread Cutting  
Hex Screw

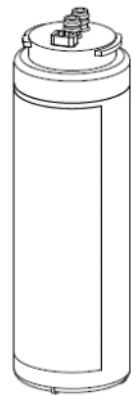

Filter  
(Filtered Models Only)

### Tools & Hardware Required:

- Electric drill/driver
- Small tubing cutter for plastic line
- 1/4" nut driver
- Means to cut 1 1/4" drain pipe
- T15 Torx screwdriver and bit
- 4 appropriate anchors (not supplied)

## Section 2: Single Level Rough-In Drawing

**NNEBFGP:**  
**NNFEBFGP:**

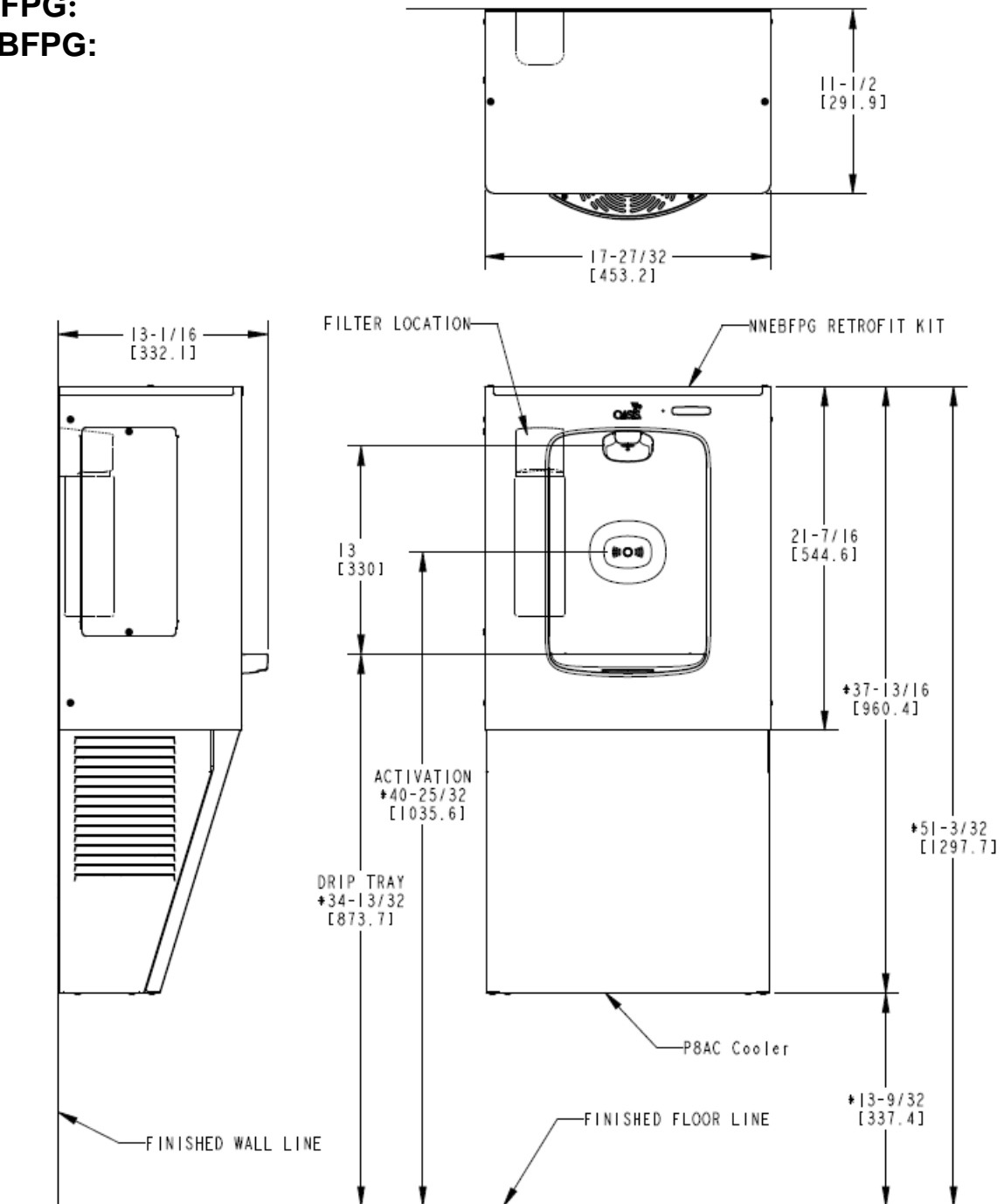

### NOTES:

1. \* DIMENSIONS ARE REFERENCE ONLY.
2. ALL DIMENSIONS ARE IN INCHES. DIMENSIONS IN BRACKETS [ ] ARE IN MILLIMETERS.

# PREPARATION

- Disassembly of P8AC Cooler
- Wiring
- Water Lines

## Section 3: Preparation

1. Remove the front panel by removing two Phillips screws under the nose assembly and by loosening the 2x #8 hex screws at the bottom.
2. Disconnect power by UNPLUGGING the unit.
3. Turn OFF water supply to the unit. Bleed any remaining pressure from the lines by activating the bubbler valve.

Loosen or  
remove 2x  
#8 Hex Screws

Remove 2 Screws

4. Loosen or remove the P-trap so that the fountain nose assembly may be freely removed in the next step.

Loosen or  
Remove

## Section 3: Preparation

5. Remove fountain nose assembly. **Tool: T15 Torx Driver**

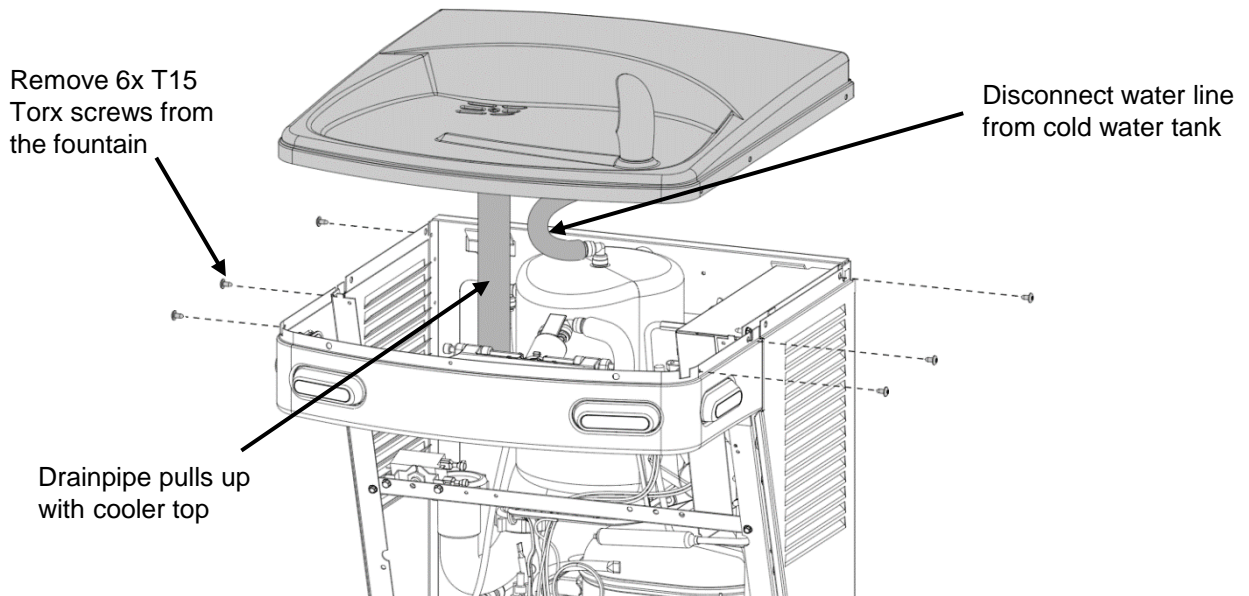

6. Remove the cooler nose assembly. On the Contractor's Choice Model, be sure to carefully remove the cold control. Keep the two cold control assembly screws. **Tool: 1/4" Nut Driver**

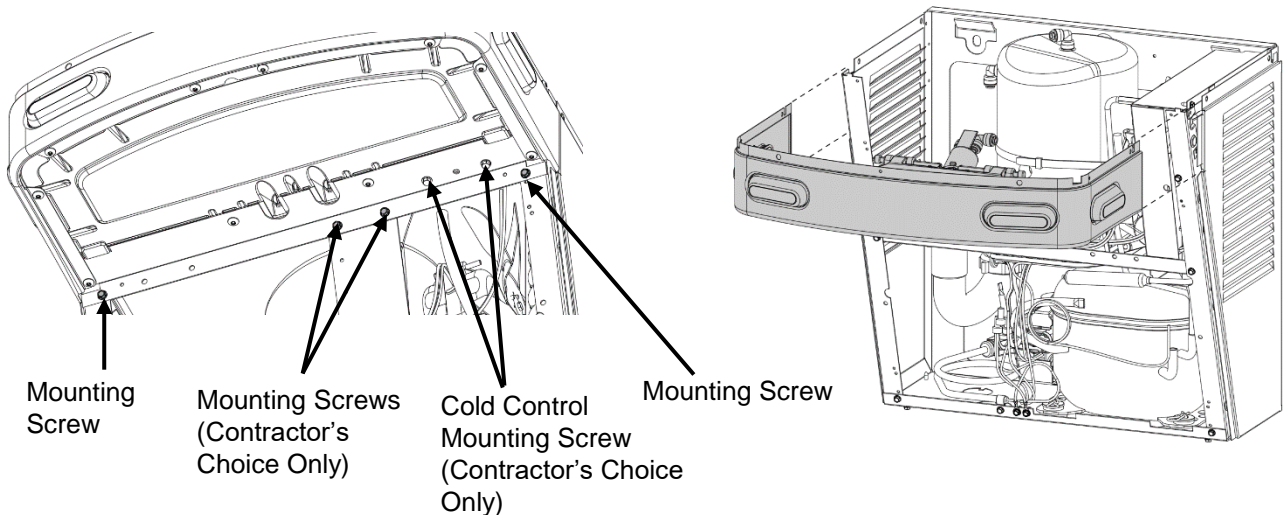

**CONTRACTOR'S CHOICE MODEL:** The cold control will be unsupported at this point. Secure it as necessary and ensure the cap tube does not kink.

## Section 3: Preparation

7. The cooling tank must be pressurized for the NNEBFPFG. If the water source line is plumbed directly into the cooling tank, the unit is already pressurized. For the filtered model NNFEFBFG move to [Section 3: Step 8](#).

To pressurize the tank, plumb the water source line directly into the cooling tank. **DO NOT** turn on the water source at this time.

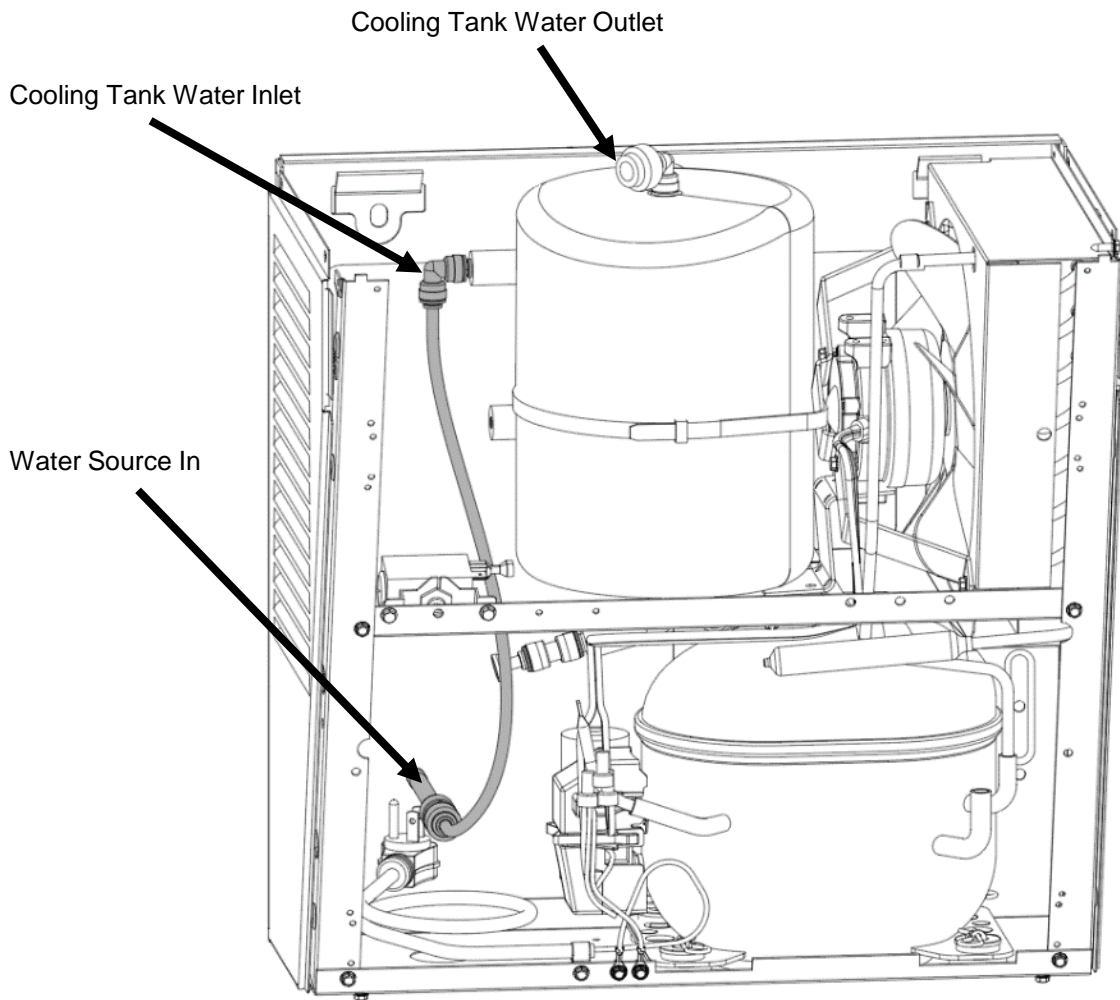

**Shown above is the correct water line orientation**

## Section 3: Preparation

8. Model NNFEBFPG with Filtration: Remove the 1/4"OD water source line plumbed directly into the cooling tank or plumbed directly to the cartridge valve on the cooler nose assembly removed in Section 3: Step 6.
9. Remove the cooling tank water outlet line attached to the cooling tank outlet but do not remove the elbow fitting.

In future steps after the NNFEBFPG frame assembly is installed the Inlet Line on the filter head assembly will be connected to the Water Source Reducing Fitting and the Outlet Line on the head assembly will be connected to the Cooling Tank Water Inlet Fitting.

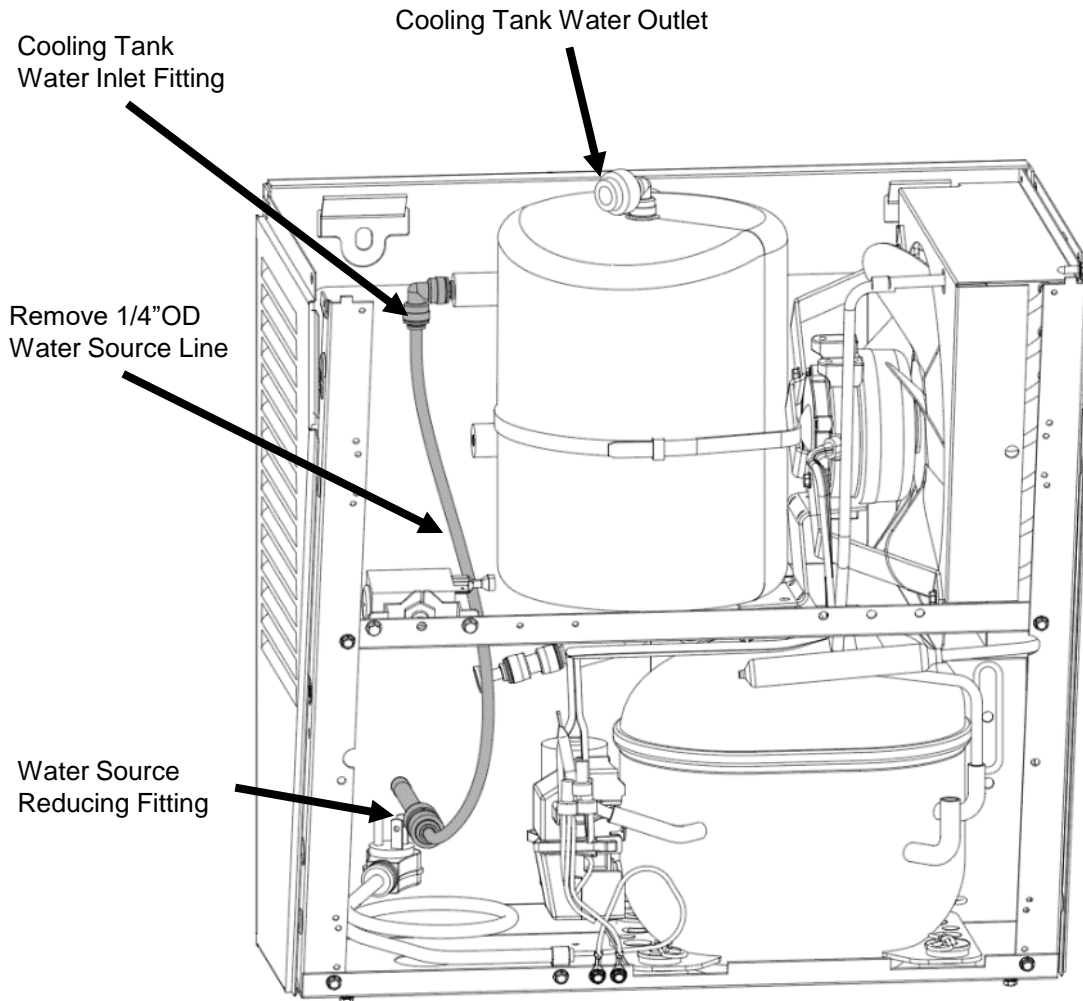

**Shown above is the correct water line orientation**



# **SINGLE LEVEL INSTALLATION**

- **Assembly of NNEBFPG & NNFEBFPG Cabinet**
- **Wiring**
- **Plumbing**

## Section 4: Installation

1. The NNEBFPG and the NNFEBFPG comes partially assembled for shipping. Remove the kit from the packaging and separate it into the assemblies and components shown below.

**Tool Needed: T15 Torx bit**

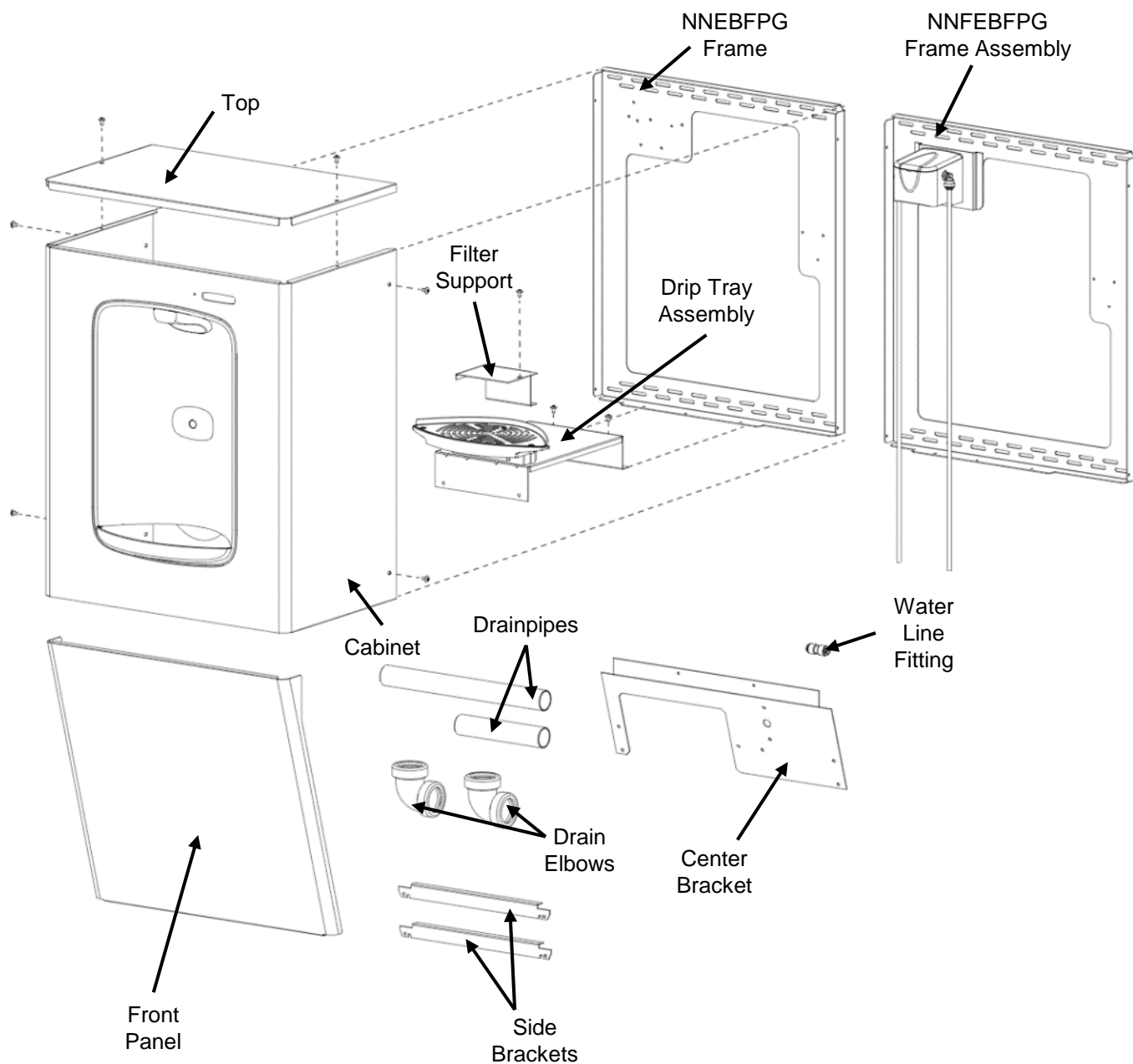

## Section 4: Installation

2. Assemble the center bracket to the holes in each of the cooler struts with 4x T15 Torx screws.

**Original P8AC Model: DO NOT RELOCATE COLD CONTROL ON THIS MODEL**

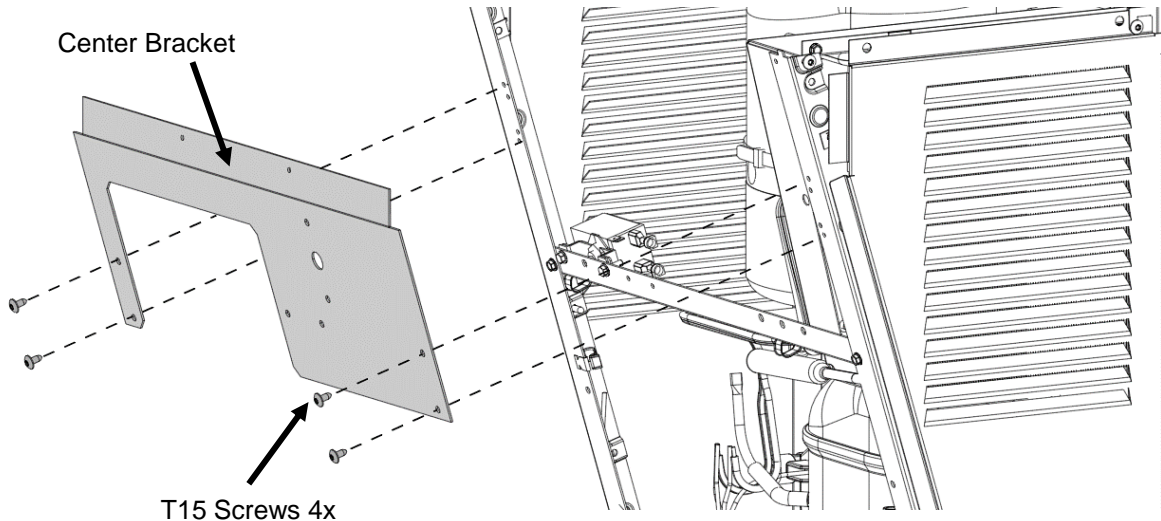

### Contractor's Choice Model:

After affixing the center bracket to the cooler, assemble the cold control to the center bracket using the original machine thread screws that were on the unit. Assemble the fan bracket to the center bracket with the original 1/4" drive screws.

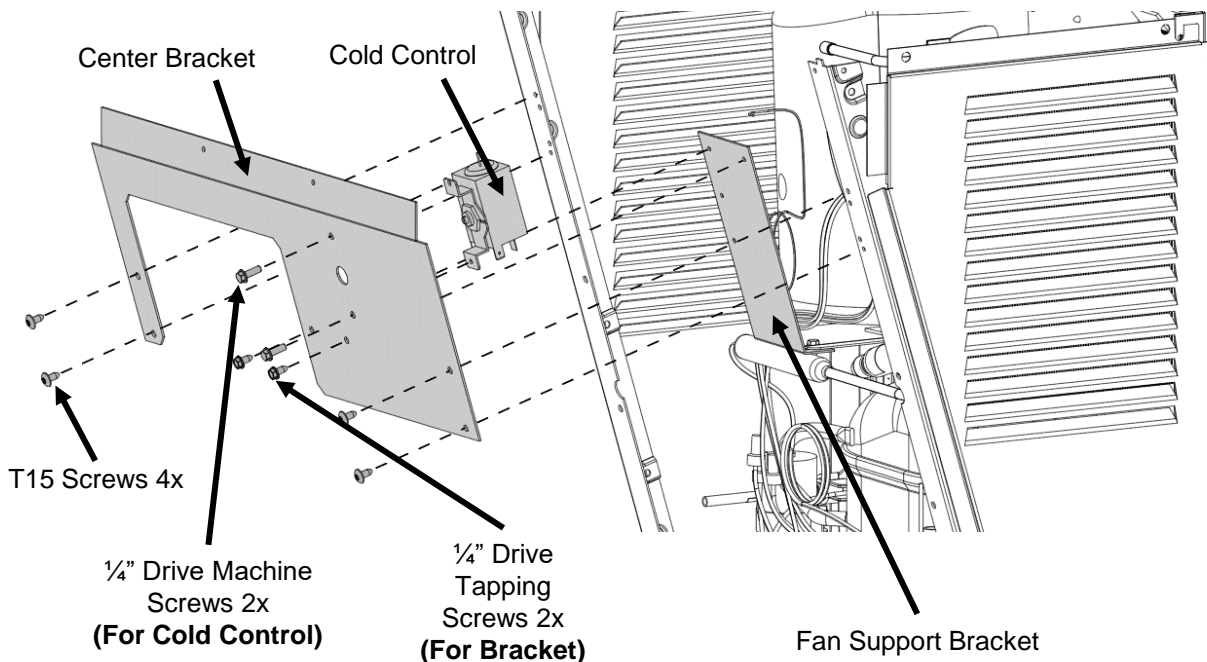

## Section 4: Installation

3. Assemble the two side brackets to the unit with two T15 Torx screws each. The brackets are identical and will work on both sides of the unit.

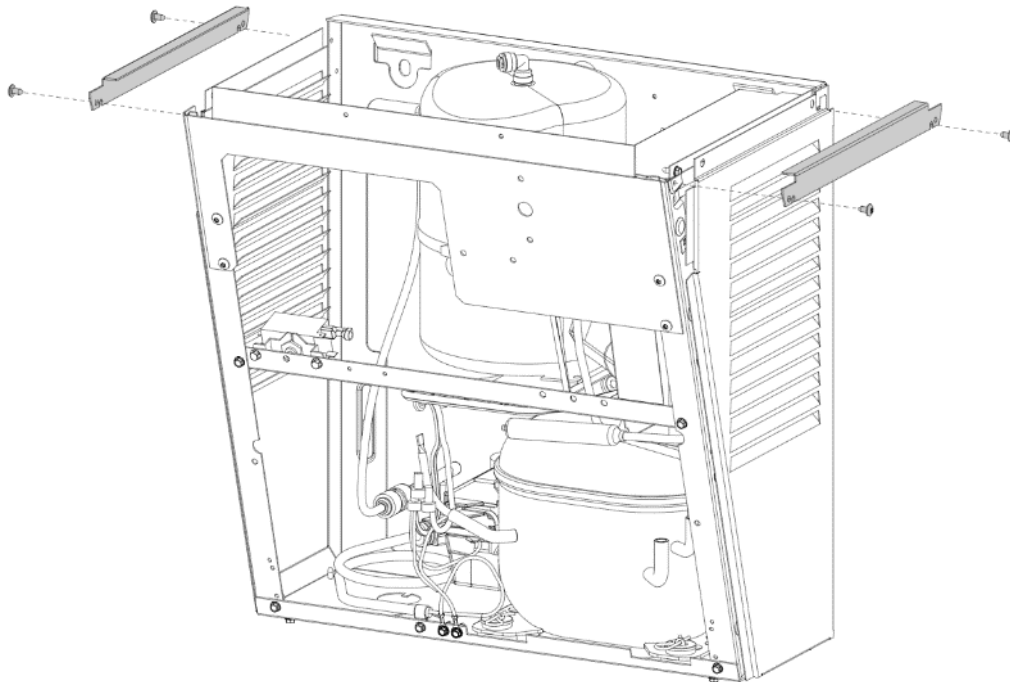

Align each bracket as shown. Use the clearance hole to attach the screw in the cooler strut (away from the wall) and use the slot to attach the bracket in the rear (closer to wall).

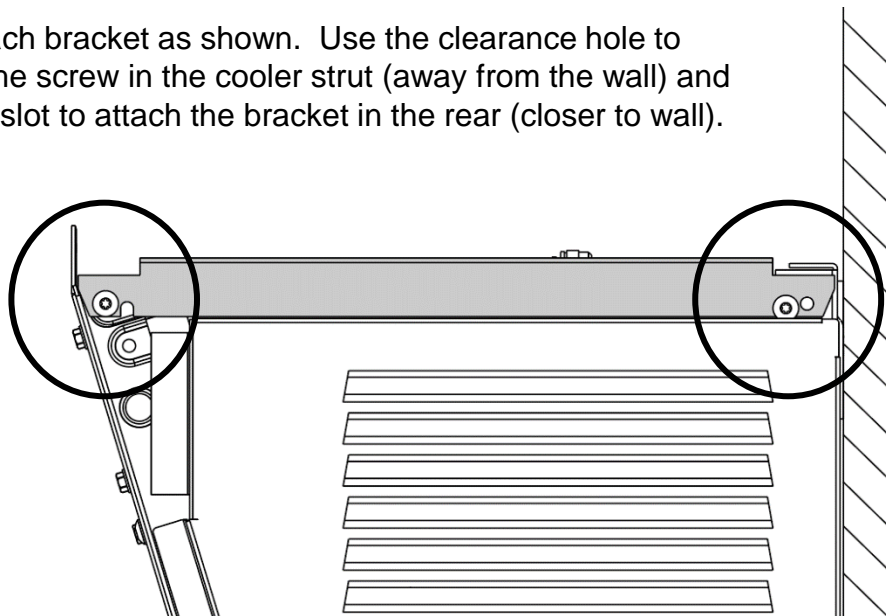

## Section 4: Installation

- Without taking the cooler off the wall, place the retrofit frame against the wall and set it onto the top flange of the cooler frame.

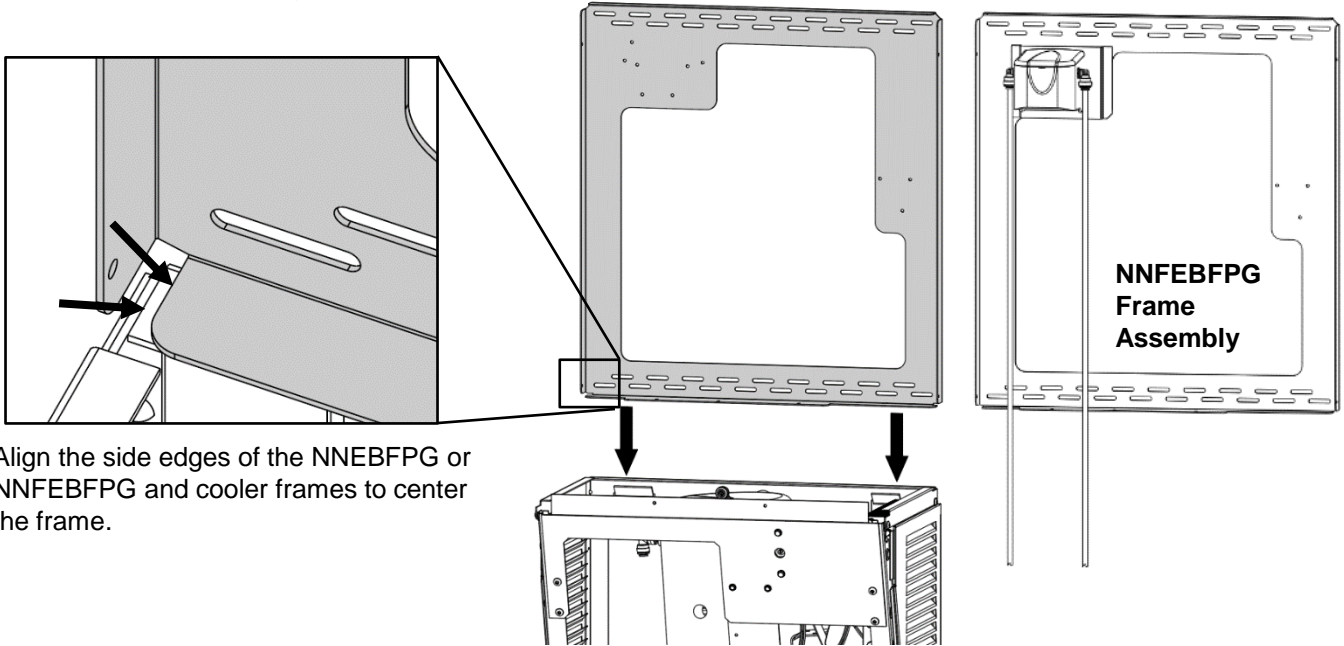

- Affix the frame to the wall with at least 4 anchors into any appropriate anchor points through the staggered slotted holes. **Be careful to ensure the frame stays centered on the cooler frame.**

Choose a minimum of 4 anchors appropriate for the surface the unit is being mounted to. Anchors are not provided.

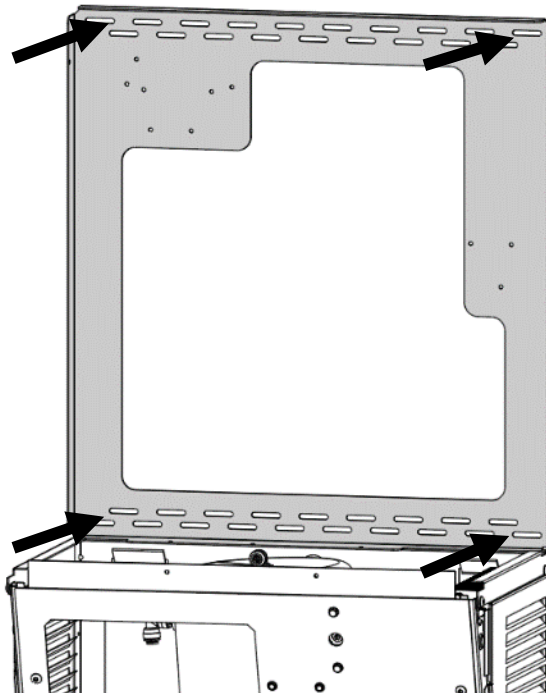

## Section 4: Installation

6. With 4x T15 Torx screws, assemble the drip tray assembly to the center bracket and wall frame.

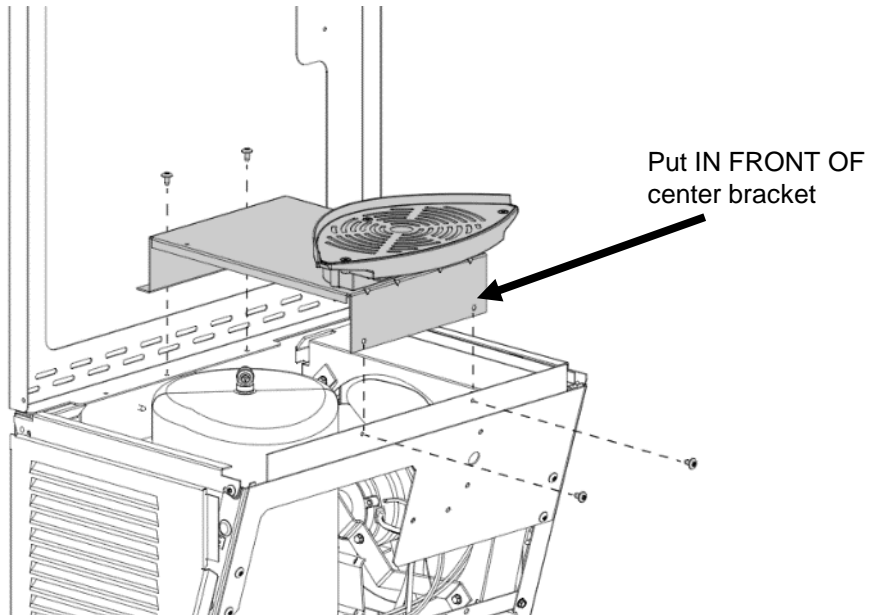

7. Attach the filter support bracket with 2x T15 Torx screws to the frame and drip tray support bracket. This bracket helps to prevent the filter cartridge from falling into the cooler unit below during installation or replacement.

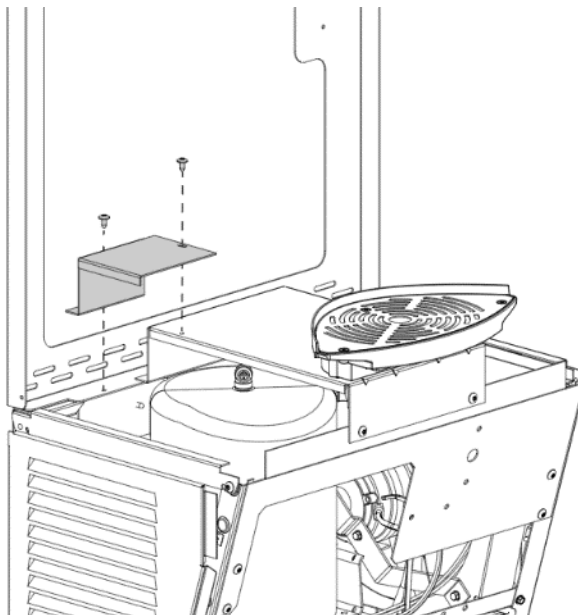

## Section 4: Installation

8. Filtered Model: Insert Filter Head Inlet Tube into water supply reducing fitting. Install filter cartridge to Filter Head Assembly. See instructions on filter cartridge for Installation Instructions and for Filter Flushing Instructions. Direct Filter Head Outlet Tube to a container to collect water for flushing the filter. Turn on water. Flush till water is clear. When flushing is complete, insert Filter Head Outlet Tube into cooling tank inlet fitting. Cut tubing if necessary.

### Model NNFEBFPG

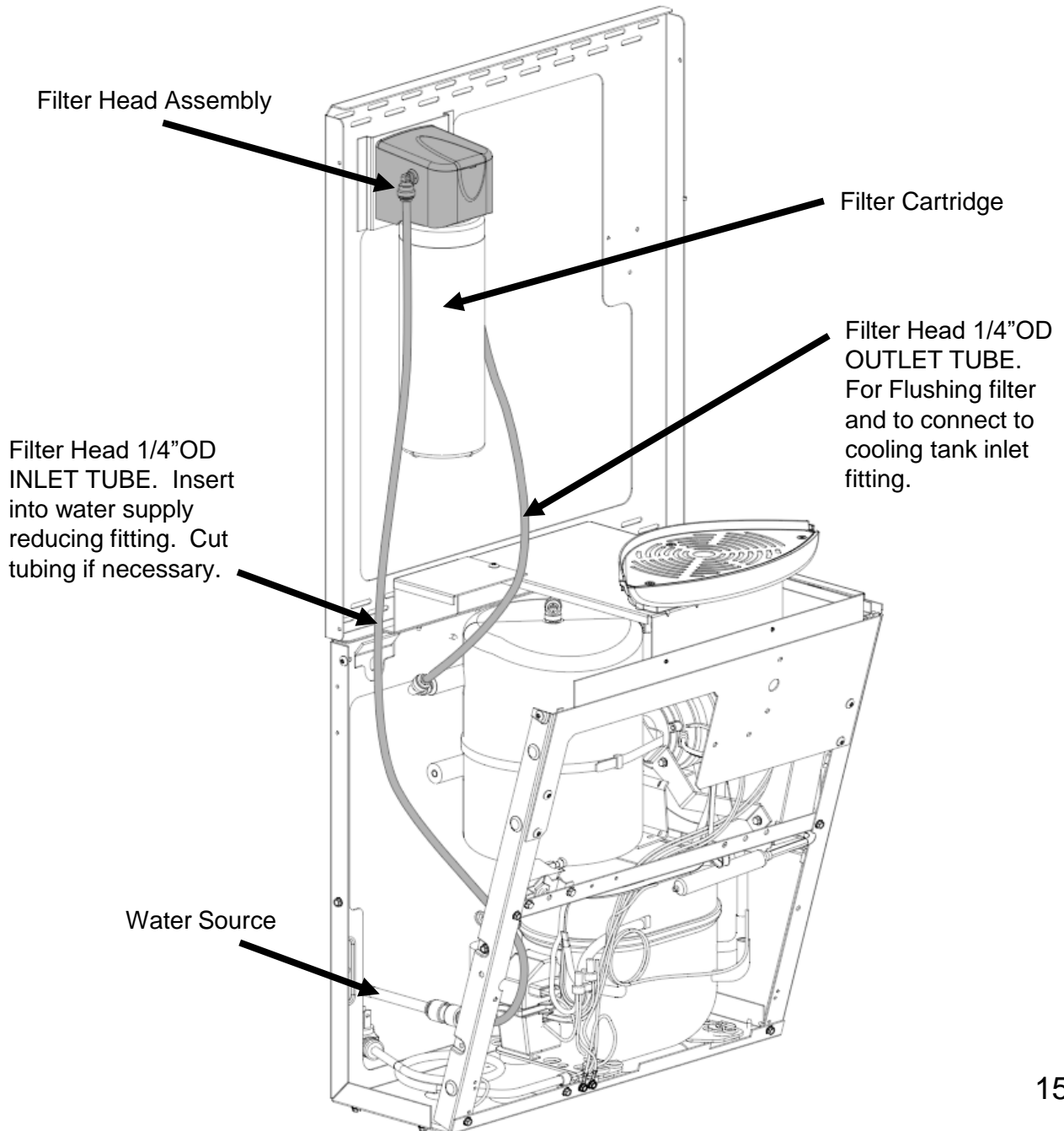

## Section 4: Installation

9. Attach one of the drain elbows to the drip tray stem. Insert the drainpipe provided into the elbow and then attach another elbow onto the pipe. Use the remaining drainpipe and connect the drip tray drainage system to the installed P-trap.

**NOTE:** Drainpipes will need to be positioned and cut to length as needed.

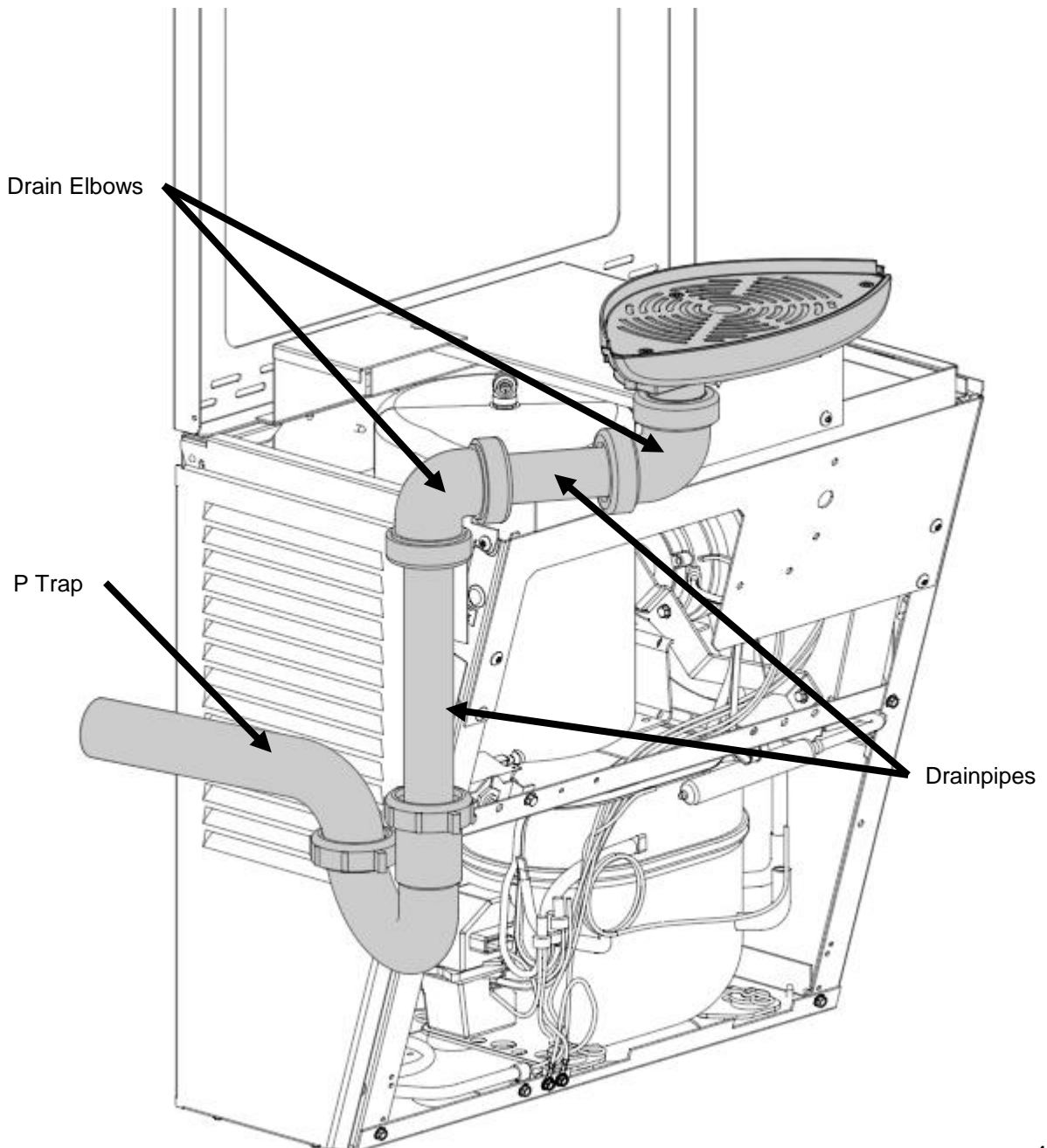



## Section 4: Installation

10. Assemble NNEBFPG or NNFEBFPG wrapper to the installed frame. Rest the alcove on the drip tray and ensure the wrapper walls rest OUTSIDE of the frame and side brackets.

**NOTE:** The drip tray will hold the weight of the wrapper but it is recommended to keep a hold on the unit during installation for safety.

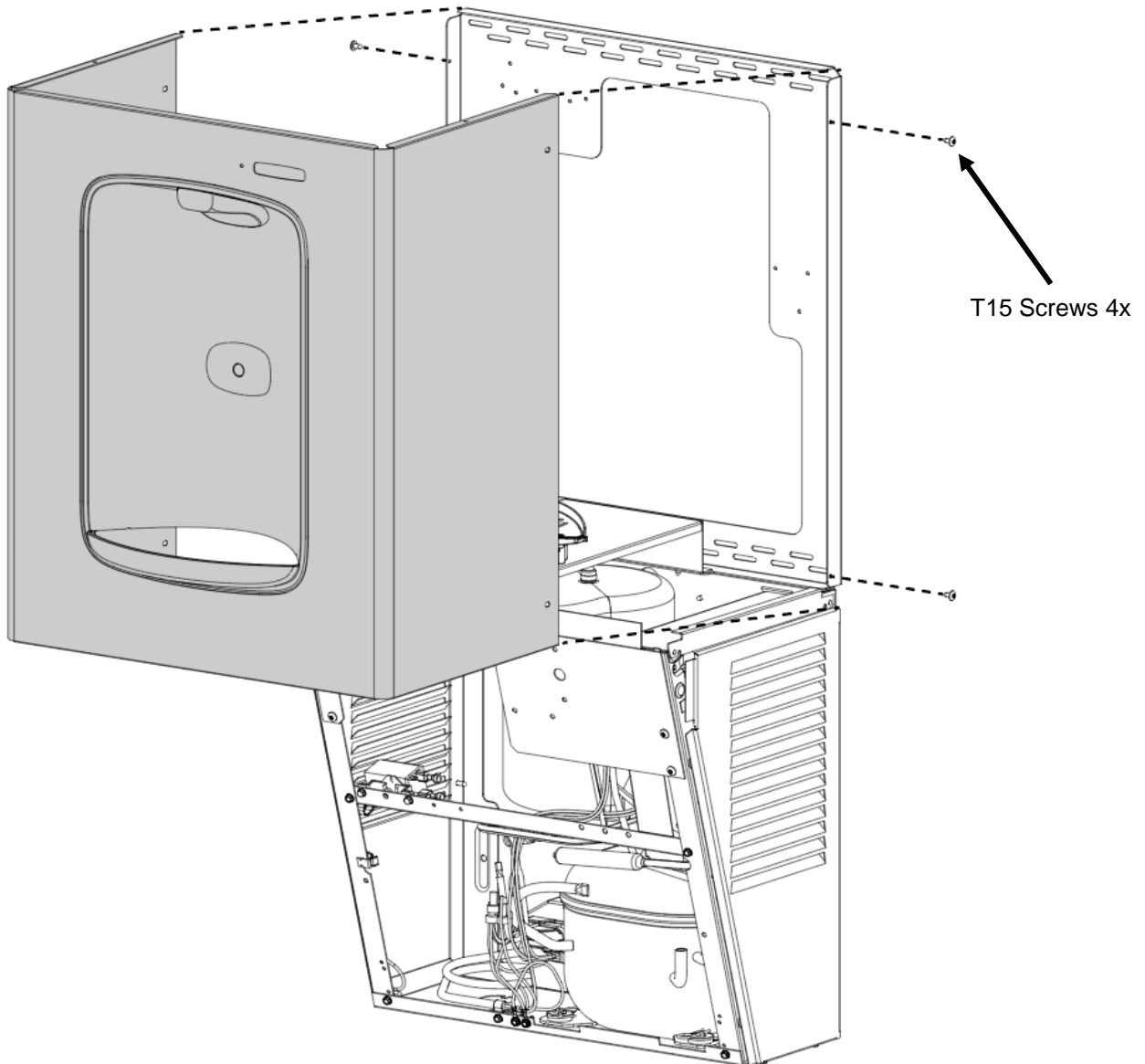

## Section 4: Installation

11. If the outer edge of the drip tray is not properly aligned, loosen the screws mounting the filter support and drip tray bracket to the frame and push forward or back as needed. Then retighten the screws.

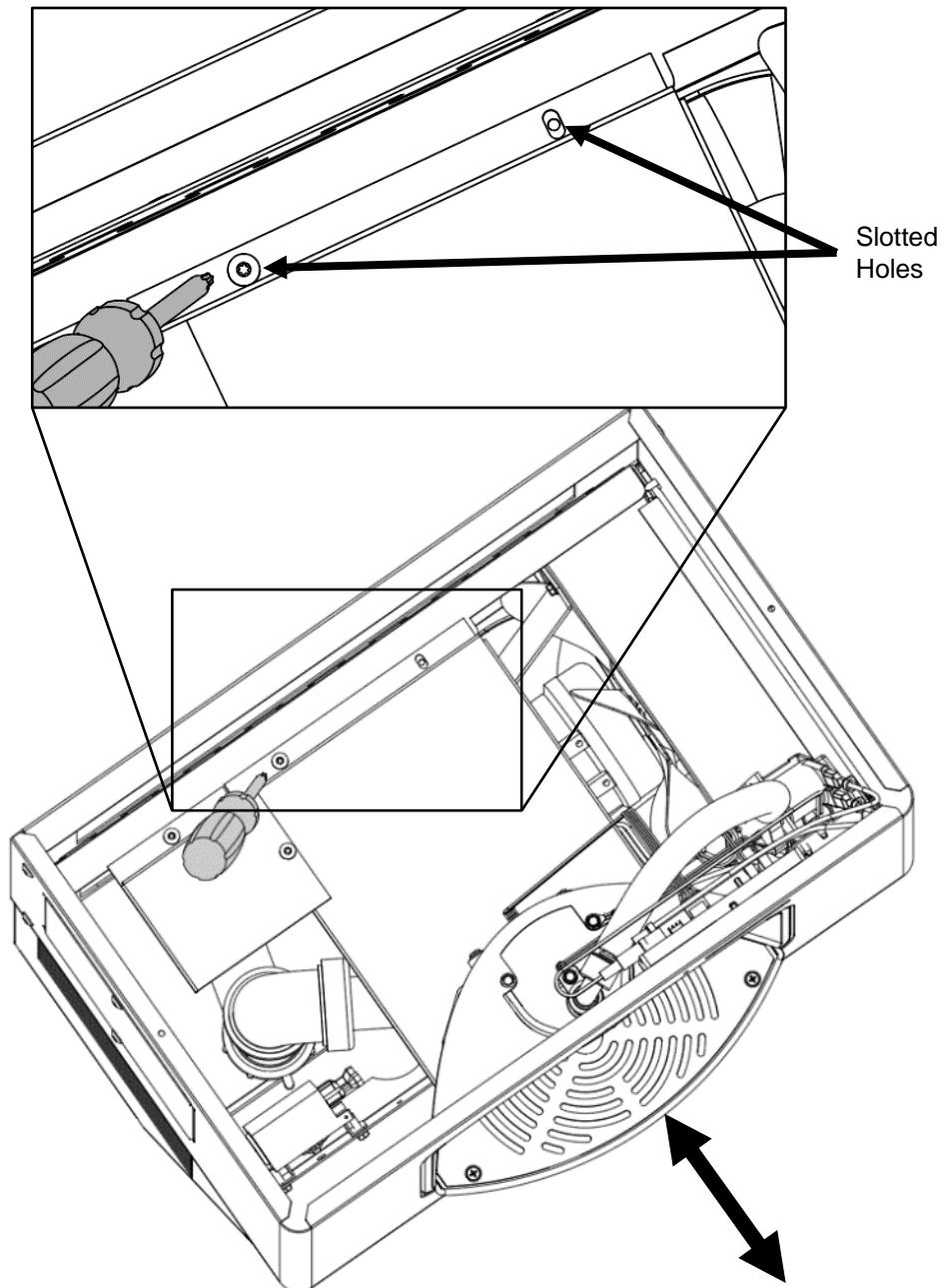

## Section 4: Installation

12. Attach the end of the provided  $\frac{1}{4}$ " water line with insulation tubing to the cold tank water outlet fitting at the top of the reservoir.

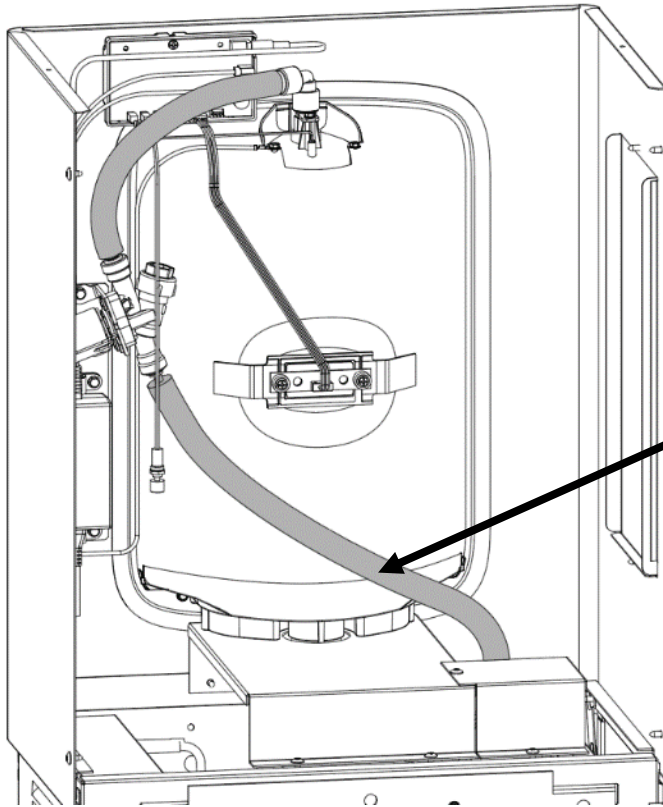

$\frac{1}{4}$ " Water Line With  
Insulation Tubing  
(Provided)

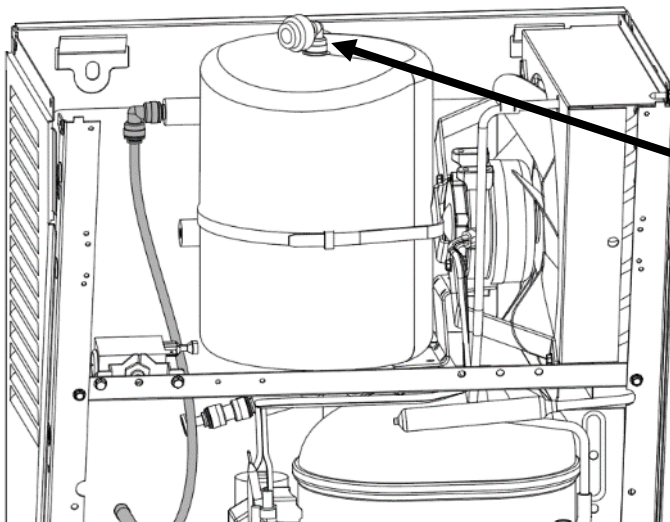

Cooling Tank  
Water Outlet

## Section 4: Installation

13. Install the strain relieving P-Clip roughly 36" from the three-prong wall plug and attach to the fountain strut with the provided #8 Hex, tapping screw. Use the clearance hole shown in the image below.
14. Attach the ground ring terminal using the provided thread cutting machine screw to an available hole on the fountain strut.
15. Connect one of the IEC connectors to the power brick behind the alcove of the bottle filler. Ensure that the free IEC connect does not become an obstruction to any moving or electrical parts.

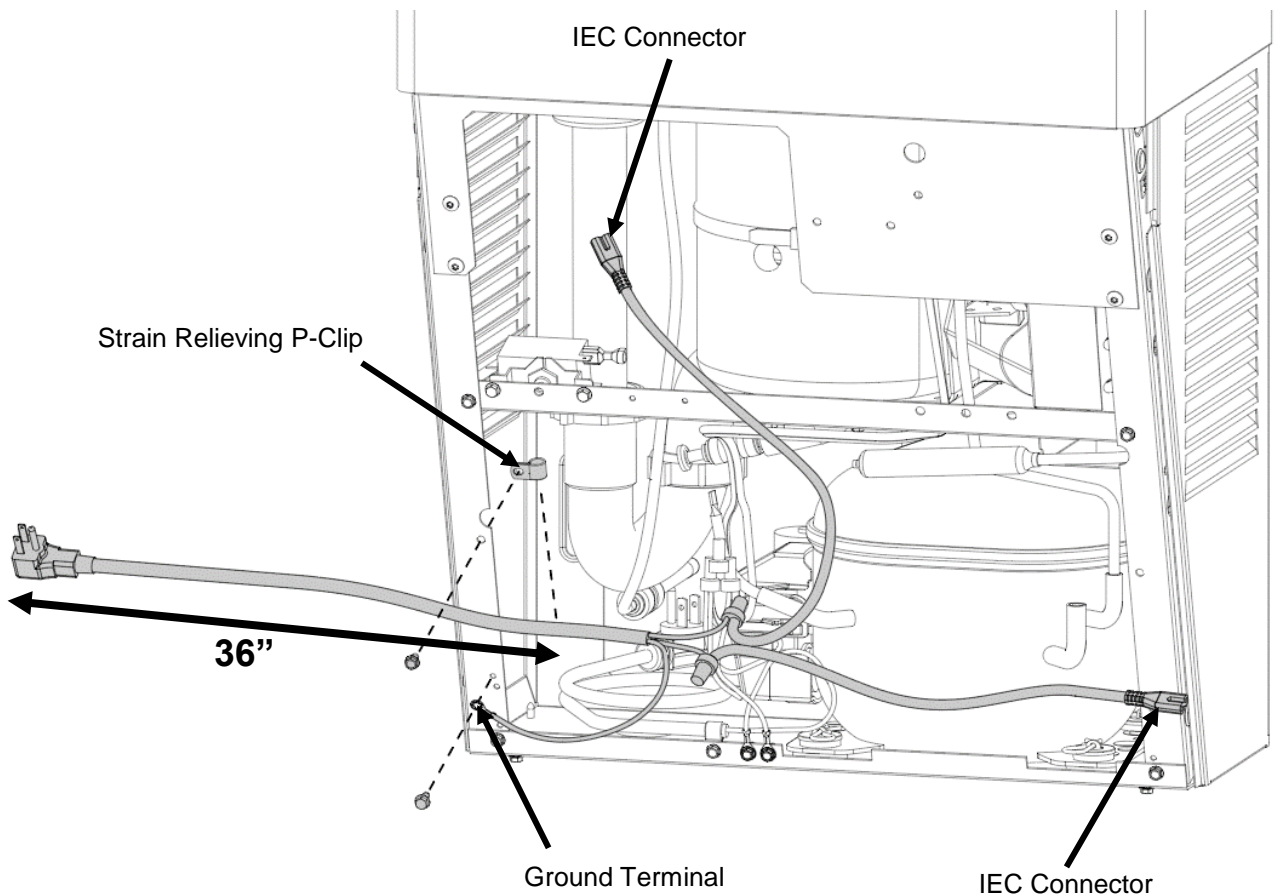

## Section 4: Installation

16. Complete the installation by turning on the water source and checking for leaks.
17. Ensure nothing is obstructing the fan blade. Plug both fountain and bottle filler power cords into the wall outlet and then test to ensure the bottle filler is functioning properly.
18. Once the unit has been verified to be functioning properly, install the front cover panel by inserting the top flange up between the wrapper and center bracket, then tipping the panel back to the fountain. Secure it with the 2x #8 hex screws at the base of the unit (refer to Step 3, page 5),

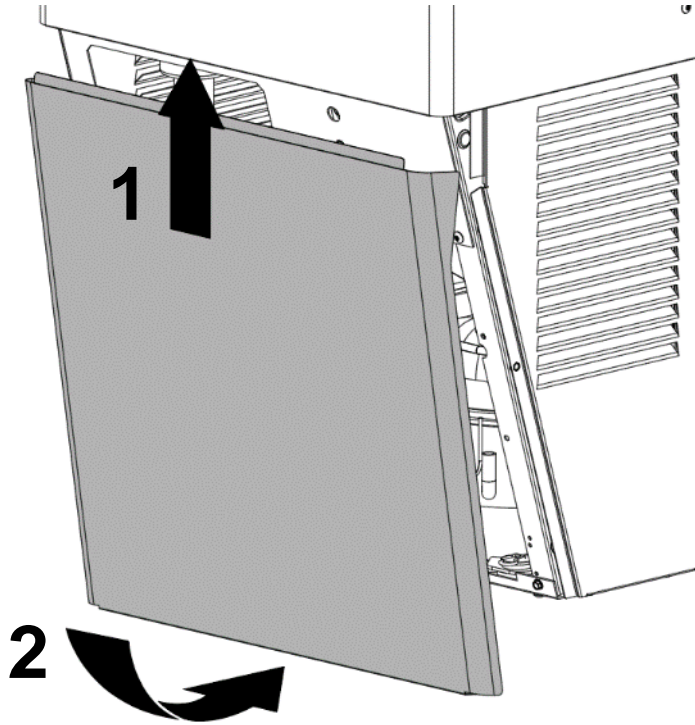

Complete the installation by installing the Top and filter access panels.

# **SPLIT LEVEL INSTALLATION**

- **Assembly of NNEBFPG and NNFEBFPG Cabinet**
- **Wiring**
- **Plumbing**

## Section 5: Split Level Rough-In Drawing

**NNEBFPG:**

**NNFEBFPG Option:**

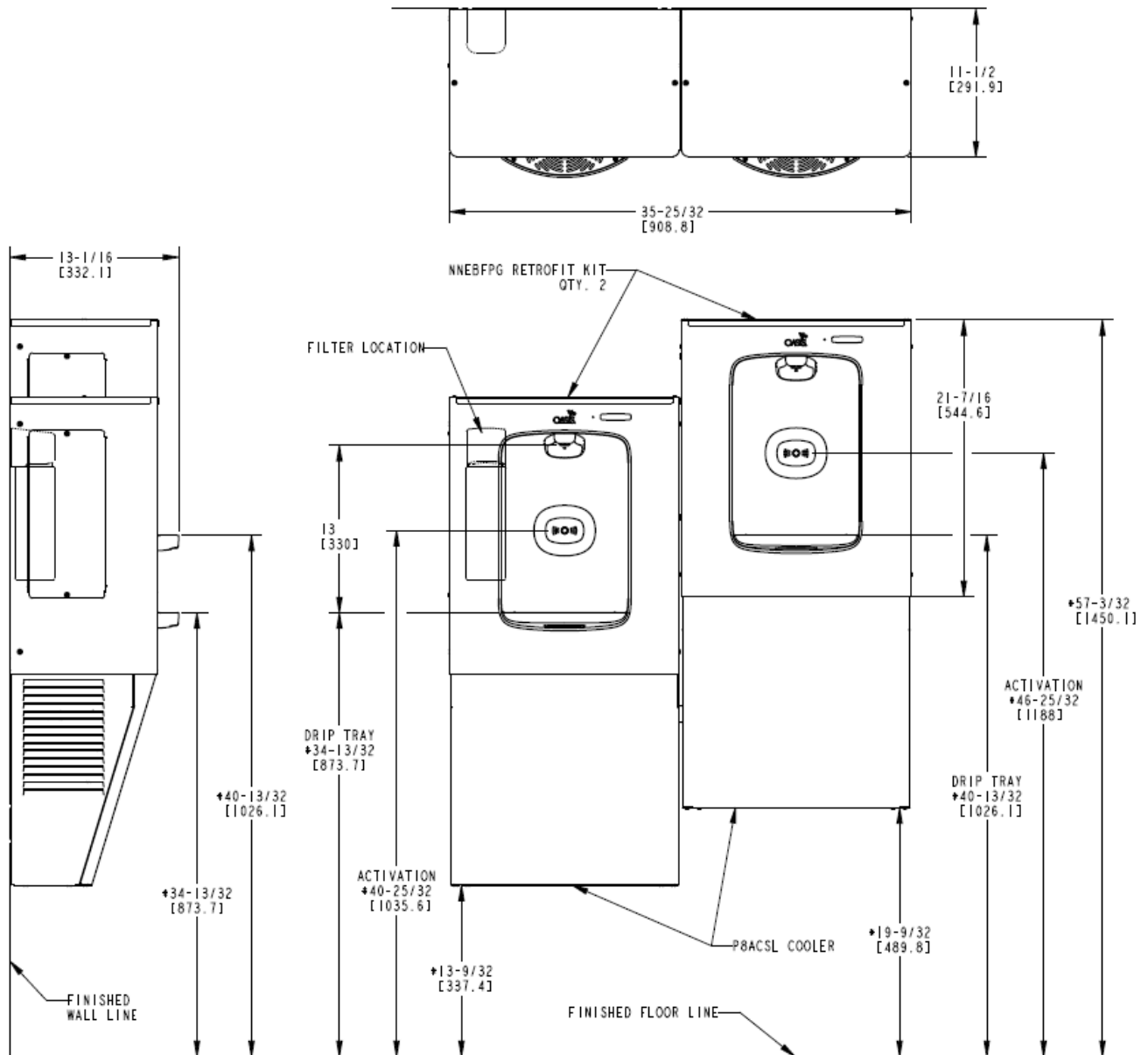

### NOTES:

1. \* DIMENSIONS ARE REFERENCE ONLY.
2. ALL DIMENSIONS ARE IN INCHES. DIMENSIONS IN BRACKETS [ ] ARE IN MILLIMETERS.

## Section 6: Split Level Installation

1. Remove the fountain wrappers and nose assembly from each unit (refer to **pages 5-6**) to prepare the units for the NNEBFPG or the NNFEBFPG installation. Unplug the fountain unit and shut off their water source.
2. Remove the drainpipes between the units but do not remove the p-trap.
3. The split-level fountain cooling tank is already pressurized. Disconnect the water source line at the reducing fitting so that the two units are no longer connected. **Ensure the water source is turned off prior to this step.**

**Note:** Have a water collection container ready to drain water from the lines.

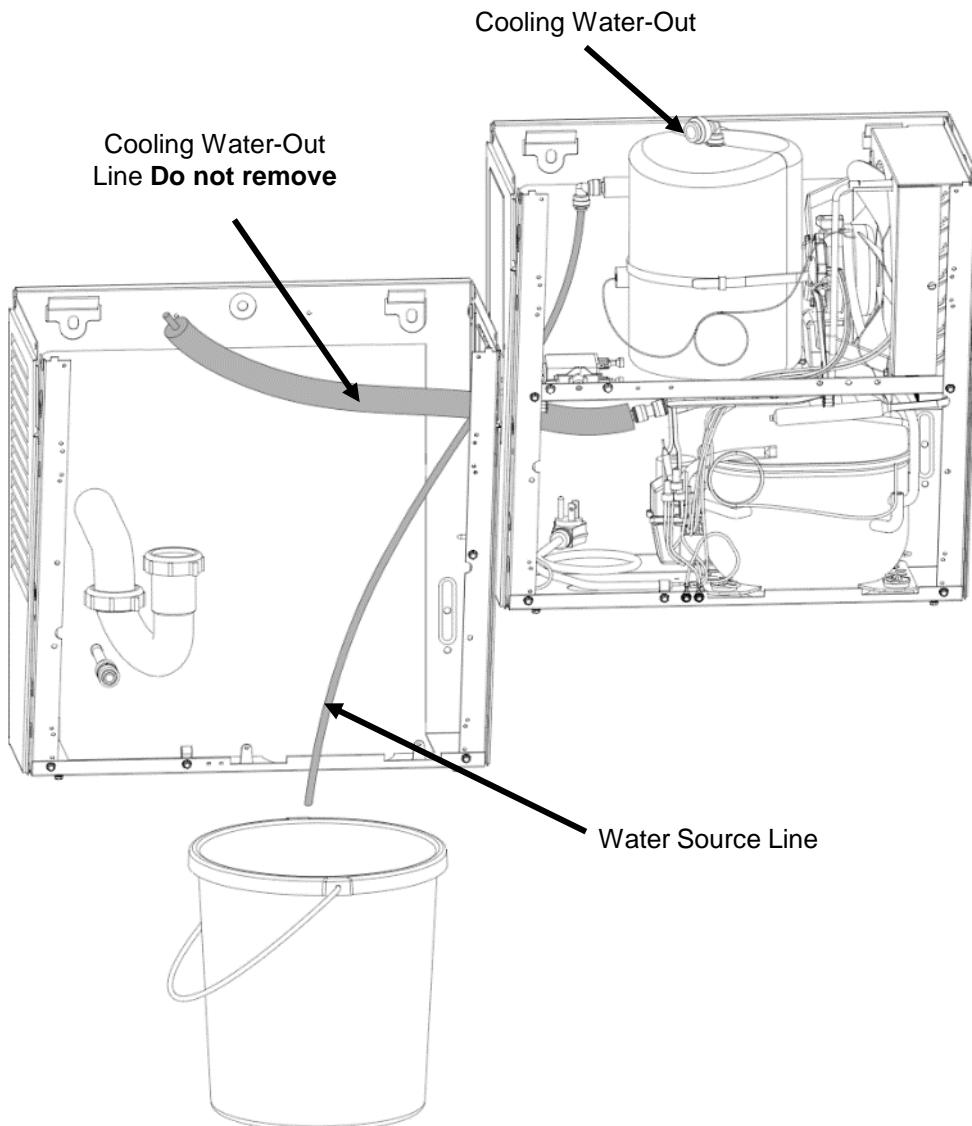



## Section 6: Split Level Installation

4. Take one of the NNEBFPG frames and center it on the dummy unit frame. Mark 4 appropriate holes for your chosen wall anchors (not provided) and then remove the frame to pre-drill the anchor points.

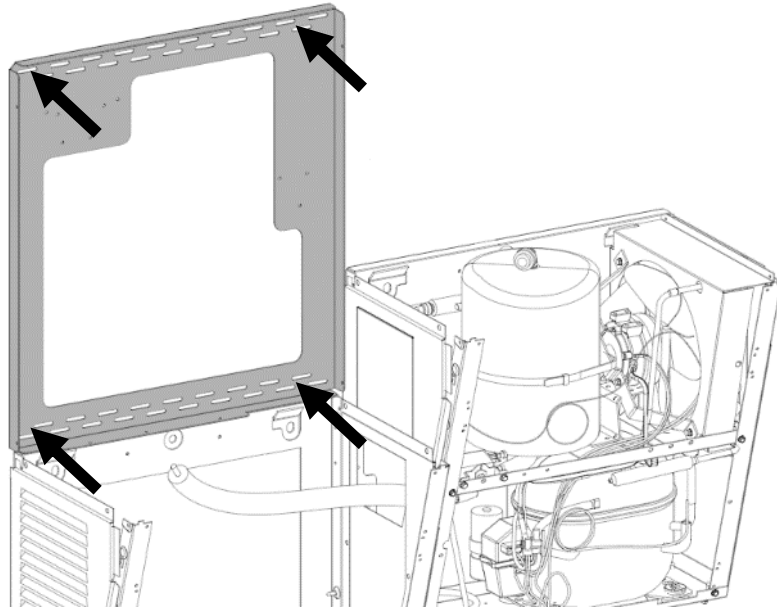

5. After the holes have been drilled, remove the dummy unit from the wall but **do not remove** the hanging bracket.

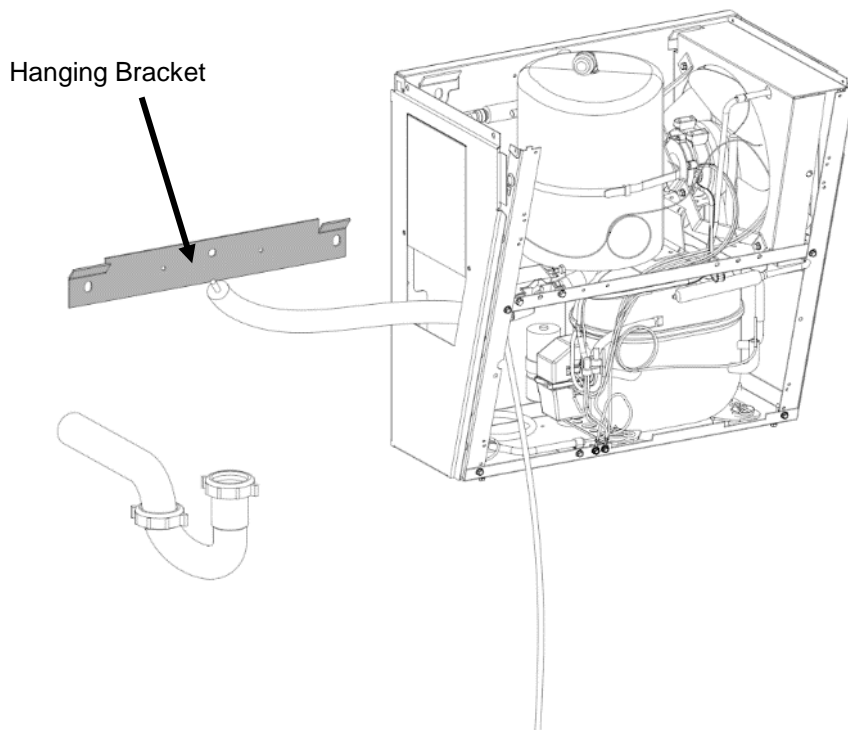

## Section 6: Split Level Installation

6. Follow the steps on **pages 10-18** and assemble the NNEBFPG kit to the **refrigerated side first**. Do not yet fully install the drainpipes and do not install the power cord.
7. While the dummy unit is still off the wall, install the center and side brackets from the second NNEBFPG or the NNFEBFPG kit to the dummy unit frame. **Refer to pages 11-12.**

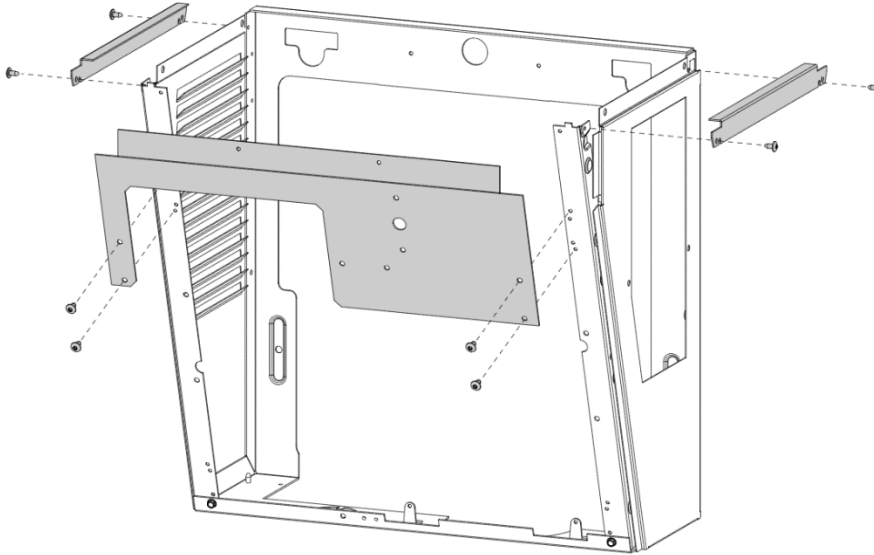

8. Lay the dummy unit on the floor and set the NNEBFPG frame or the NNFEBFPG frame assembly onto the unit and then install the drip tray bracket assembly with the T15 Torx screws provided. **Refer to page 14.**

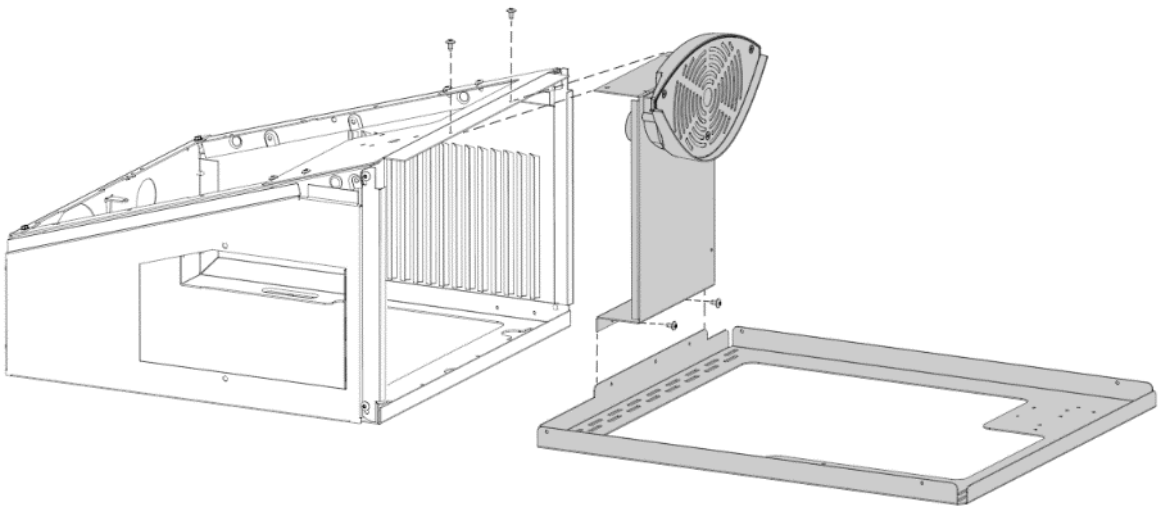

## Section 6: Split Level Installation

9. Remove the top panel from the NNEBFPG or NNFEBFPG wrapper assembly and lay the wrapper over the assembled frame and drip tray. Secure with 4x T15 Torx screws provided. Refer to **page 17**.

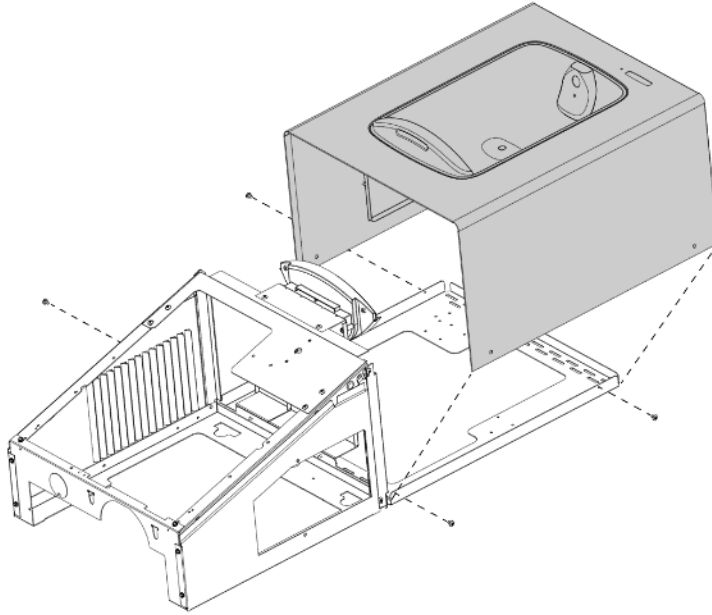

10. Carefully lift the assembled dummy unit by taking hold of the fountain frame and NNEBFPG or NNFEBFPG kit. Hang the assembly back on the vacant wall hanging bracket.

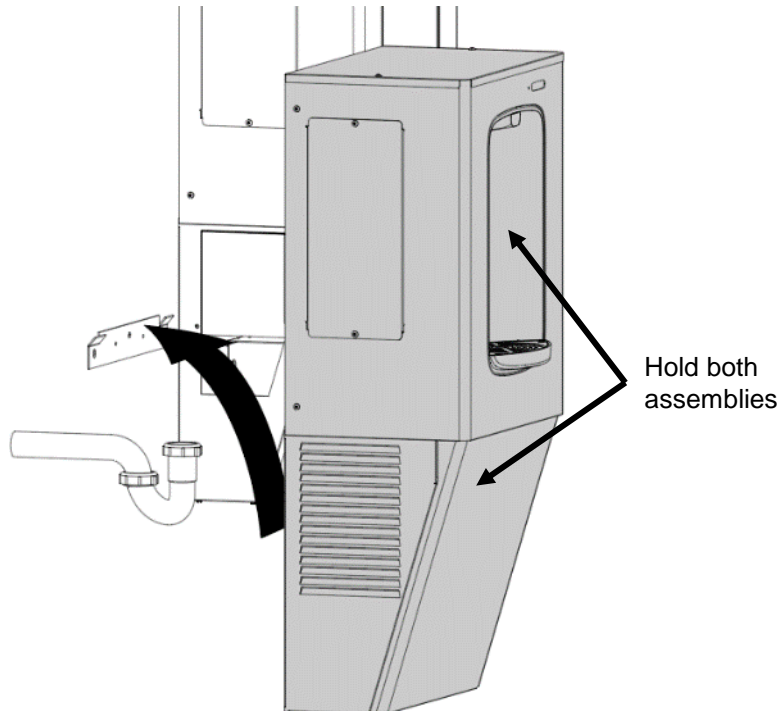

## Section 6: Split Level Installation

11. Ensure that the frame and fountain are flat against the wall and install your 4 chosen wall anchors (not supplied) to secure the NNEBFPG frame or the NNFEBFPG frame assembly to the wall. Ensure that the NN(F)EBFPG frame remains centered on the dummy unit frame. **Refer to page 13.**

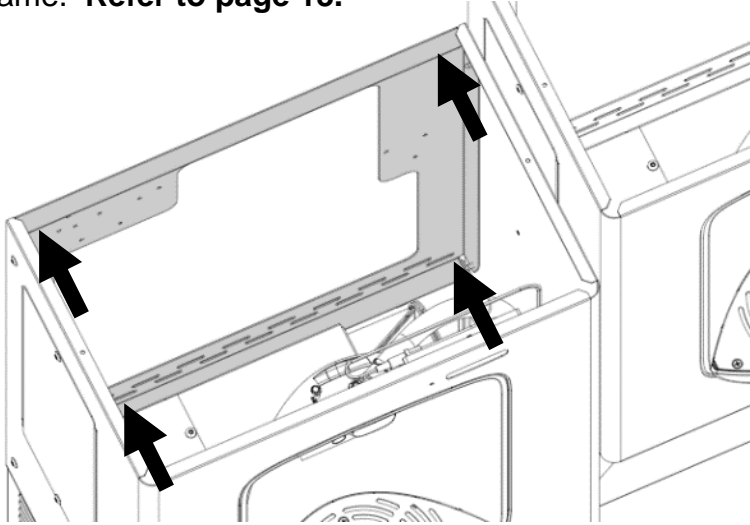

12. Install the Filter Guard Bracket. Refer to **page 13**.

13. Connect the two kits by re-installing the split level drainpipes to the NN(F)EBFPG drainpipes as shown below by connecting them to the drainpipes and fittings provided. Cut the provided drainpipes as needed.

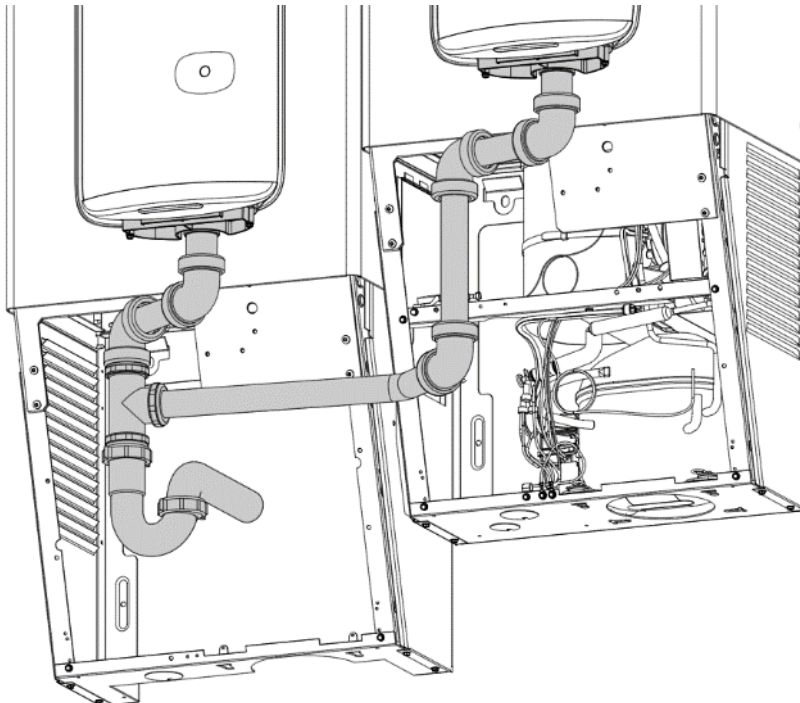

## Section 6: Split Level Installation

- 14A. Reconnect the water source line to the water reducing fitting but, **DO NOT** turn on the water.
- 14B. Model NNFEFBPG with Filtration, remove the water source line at the cooling tank water inlet fitting. See Section 4: Step 8 for connecting Filter Head Water Inlet & Outlet Lines, installing the Filter Cartridge on the Filter Head and Flushing the Filter.
15. Only one of the power cords from the two NN(F)EBFPG kits will be used. Install the strain relieving p-clip roughly 36" from the three-prong wall plug. Secure the p-clip to the frame using the #8 hex tapping screw provided. **DO NOT plug in the unit.**

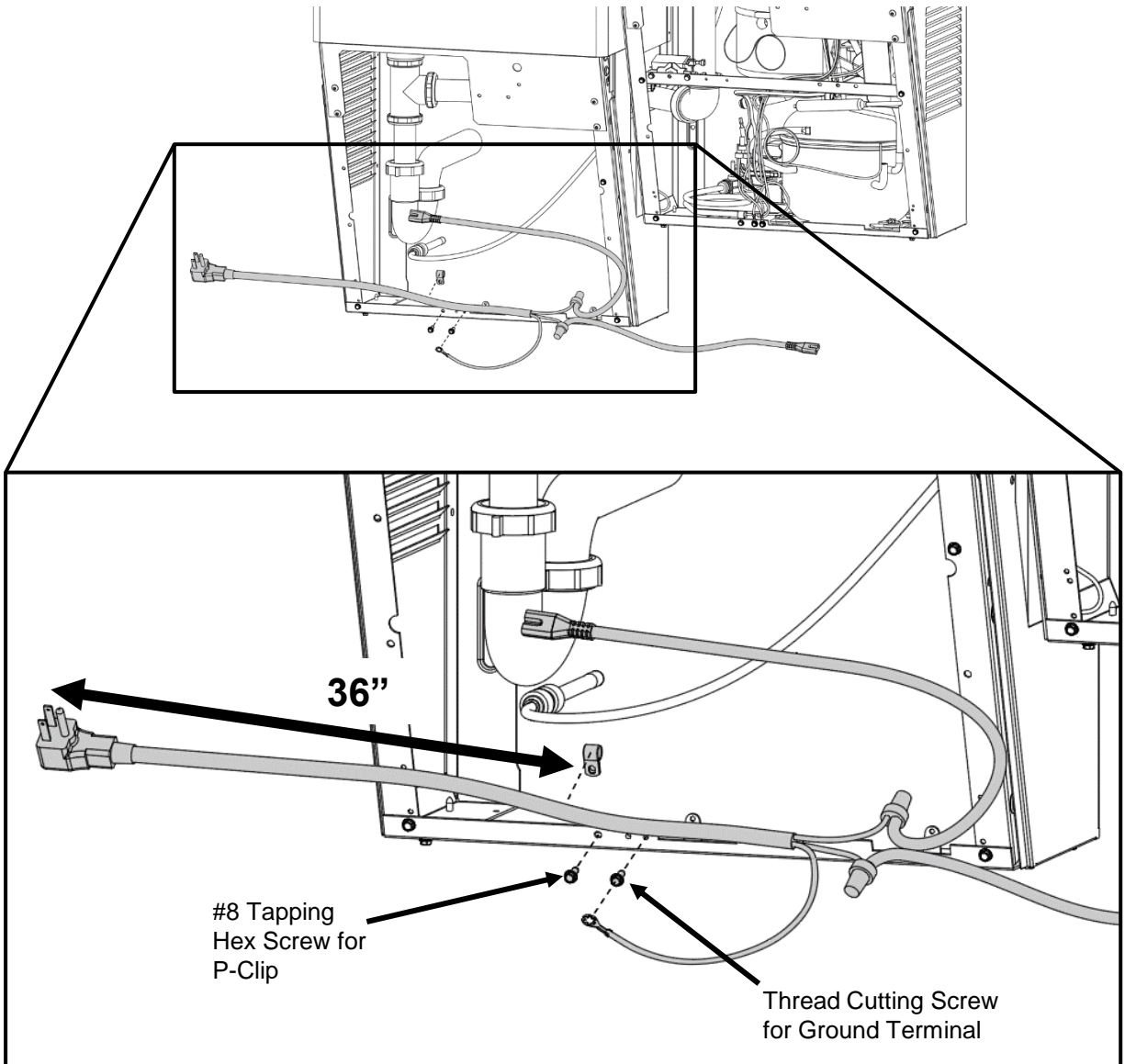

## Section 6: Split Level Installation

16. Connect each of the power bricks in each NN(F)EBFPG kit with one of each of the two IEC connectors. Ensure that the wires will not obstruct the fan blade.

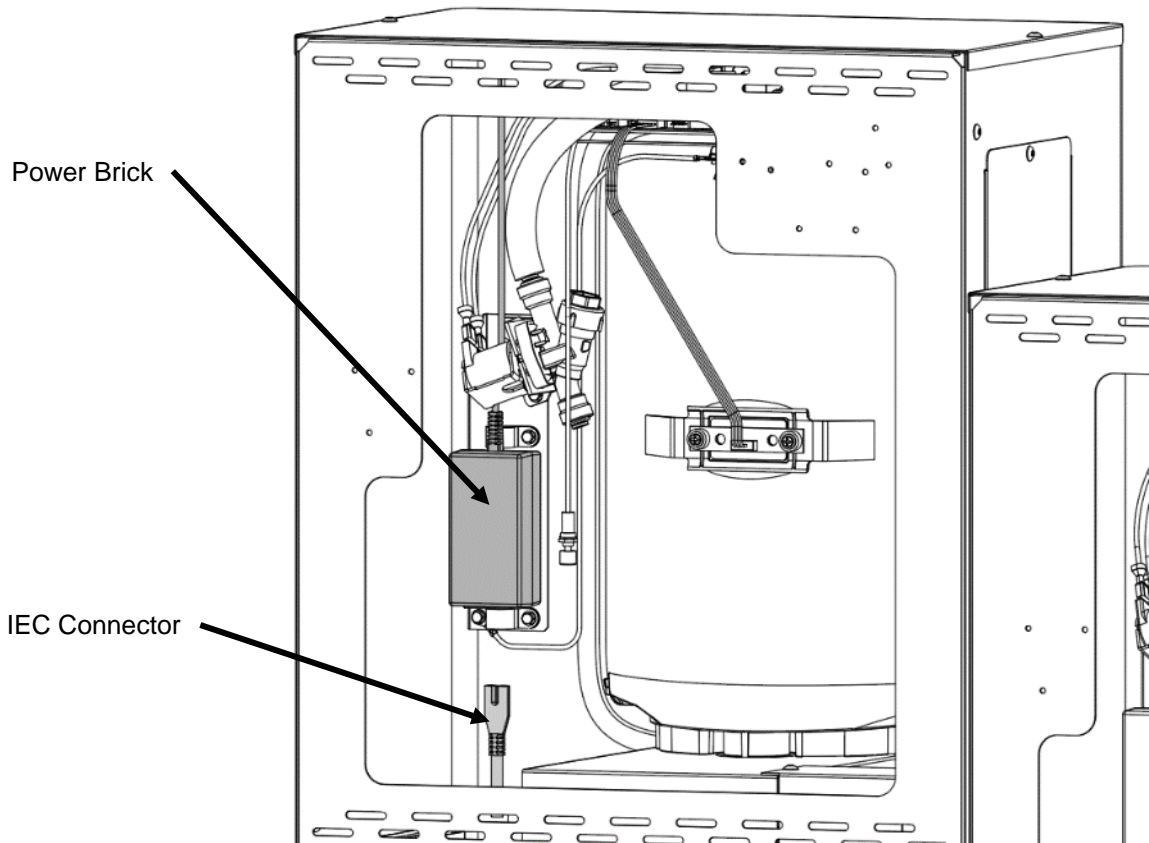

17. Connect the provided insulated water tubing to the cooling tank water out fitting. Refer to **page 19**.
18. Turn on the water to the units and check for leaks.
19. Plug in both power cords into the duplex outlet and check for proper functions. **NOTE:** The bottle filler program should be set up specific for that installation and for any filters utilized. Refer to "Set-Up Guide for Oasis Hands-Free Bottle Filler."
20. Install the fountain front panels (refer to **page 20**). Next, install the NN(F)EBFPG top and filter access panels (if removed) to complete the retrofit kit installation.

**THIS PAGE IS INTENTIONALLY LEFT BLANK**

# Model NNEBFPG and NNFEBFPG Chilled Bottle Filler Retrofit Kit for OASIS P8AC Water Coolers

## Installation Instructions

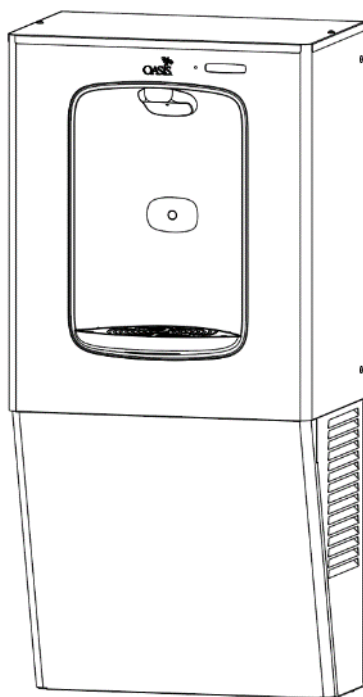

P/N 030099-702 Rev A. Date: 02/2024  
© 2023 LVD Acquisition, LLC

Oasis, Aqua Pointe, Versacooler and VersaFiller are registered trademarks of  
LVD Acquisition, LLC dba Oasis International



OASIS INTERNATIONAL  
222 East Campus View Blvd.  
Columbus, OH 43235  
614-861-1350  
[www.oasiscoolers.com](http://www.oasiscoolers.com)