



Water Coolers

FREE-STANDING HEAVY DUTY NSFS13L

Model

NSFS13L delivers 13.3 gph of chilled drinking water.

Standard Features

- > Waterways are Lead-Free in Materials & Construction
- > Dial-A-Drink® Bubbler
- > Stainless Steel Top
- > Heavy-Gauge Steel Cabinet With Separate Base
- > High-Efficiency Cooling Tank and Coil
- > Refrigerant R-134a
- > Product Certified to NSF/ANSI Standard 61, Annex G (AB1953)
- > Limited year Warranty

Finishes

- > Standard Cabinet Finish: Sandstone powder coated paint on galvanized steel
- > Optional finishes (at additional cost): Stainless Steel and optional powder coated finishes.

Accessories

- > Glass Filler - Push Handle (029603-004)
- > Glass Filler - Push Back (029603-005)
- > Glass Filler - Push Down (029603-005)
- > Kit 031505-001 is required for Field Installation for the above glass fillers
- > Foot pedal operated

Installation

- > Prior to roughing-in, consult local, state and federal codes
- > Shipped with complete instructions

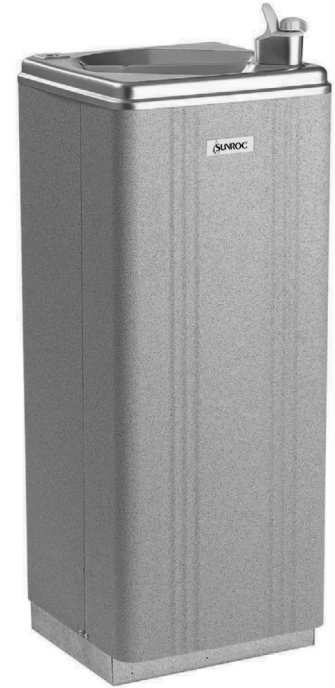

Components in this fountain are lead free as defined by the Safe Drinking Water Act Amendments of 1986, and the Lead Contamination Control Act of 1988.

Limited 5-Year Warranty (Continental limits of the United States and Canada): Five years on the sealed refrigeration system and most components parts. Detailed warranty certificate enclosed with each water cooler; sample copy available upon request.

Export Warranty:

One year on sealed refrigeration system and most components parts. Four-year replacement contract on sealed refrigeration system. Detailed warranty certificate enclosed with each drinking fountain; sample copy available upon request.

Product Certified to NSF/ANSI Standard 61, Annex G (weighted average lead content of $\leq 0.25\%$) and is in compliance with California's Health & Safety Code Section 116875 (commonly known as AB1953).

Models covered by these specifications comply with all known Plumbing Codes. Listed by Underwriters' Laboratories to U.S. and Canadian Safety Standards.



| Model | 50° F Drinking Water 90° F Ambient Air Temp* | | | | 115 Volts, 60 HZ | | | Glass Filler Acc. Option | Cabinet Color Finish | Net Wt. Approx. |
|---------|---|------------------|------------|----------------------|------------------|-------------------|----------------|-----------------------------|-------------------------|--------------------|
| | Rated Capacity GPH | Base Rate GPH | Pre-Cooler | Hot'N Cold™ Model | Compr. HP | Full Load Amps | Rated Watts | | | |
| NSFS13L | 13.3 | 7.0 | Yes | No | 1/4 | 4.4 | 500 | Yes | Yes | 80 Lbs. |

*Industry Standard Rating Condition 80° F inlet water temperature.

Specifications subject to change without notice

SUNROC® FREE-STANDING HEAVY DUTY WATER COOLER MODEL NSF5131L

ALL DIMENSIONS ARE IN INCHES.
 DIMENSIONS IN PARENTHESES ()
 ARE IN MILLIMETERS.
 ALLOW 4" (102) BETWEEN REAR OF WATER
 COOLER AND WALL FOR VENTILATION.

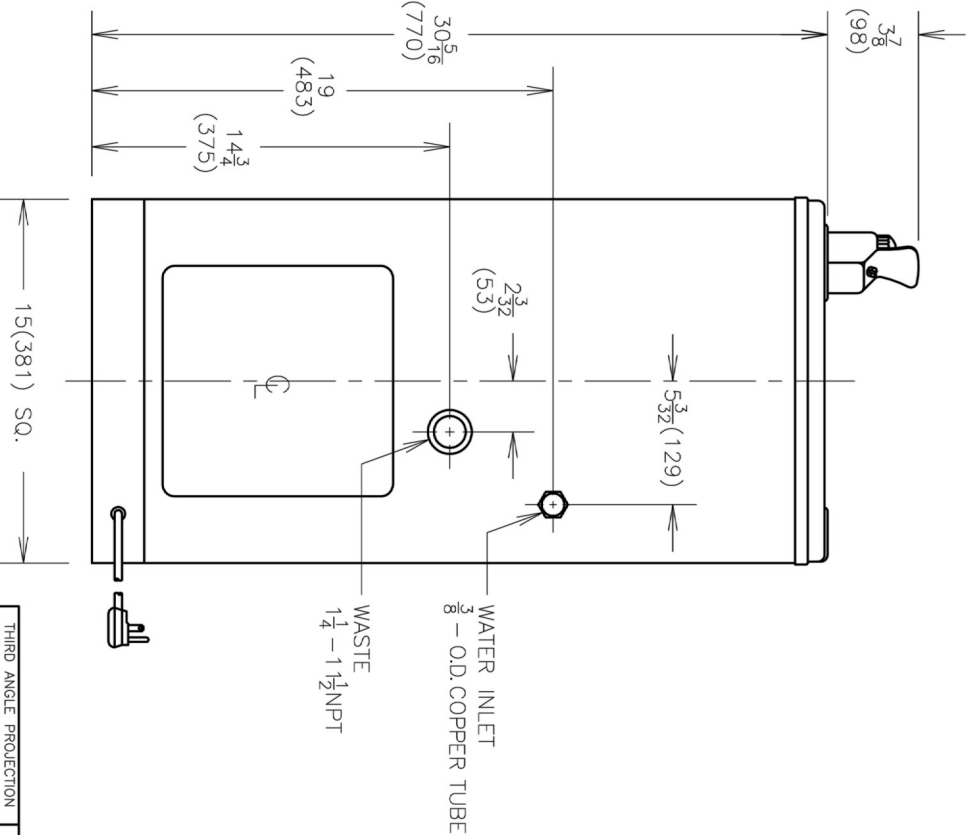
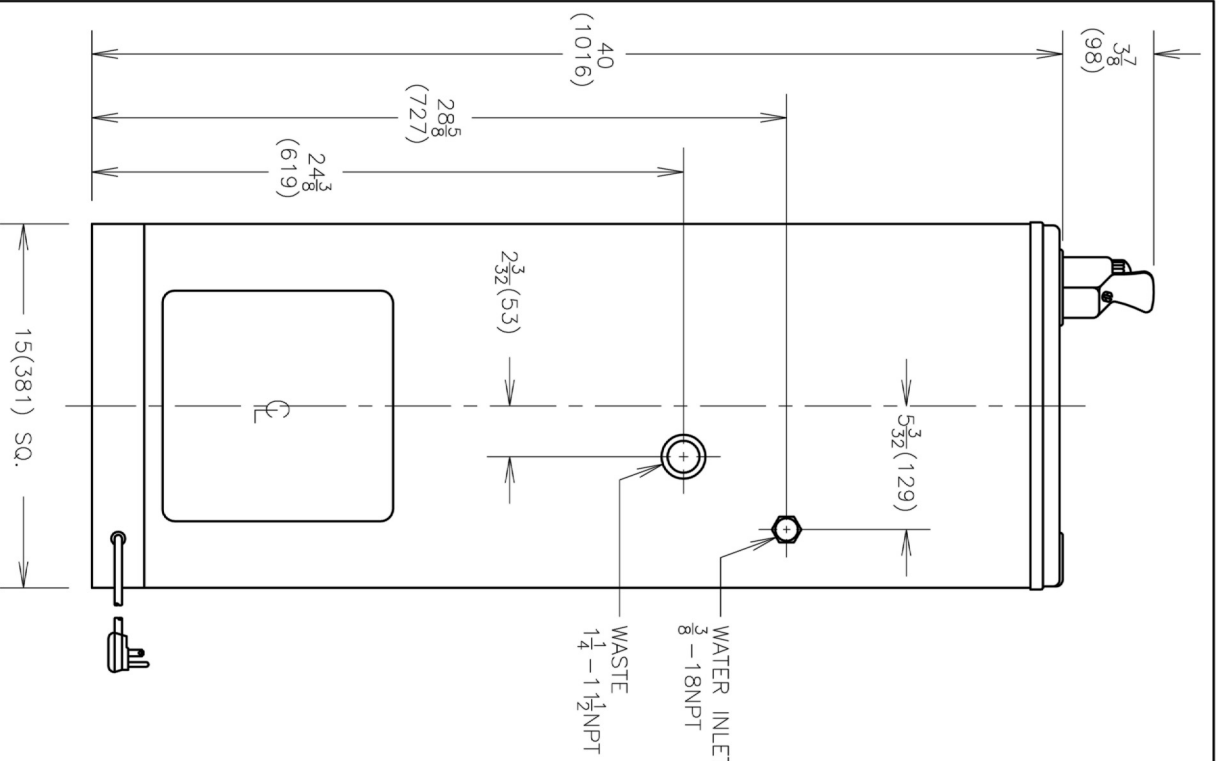

| | |
|-------------------------------|---|
| <p>THIRD ANGLE PROJECTION</p> | <p>ROUGHING-IN AND DIMENSIONAL DRAWING</p> |
|-------------------------------|---|